

Drop Forged Turnbuckles

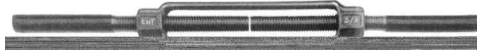

(Class B)



(Class C)



(Class B)

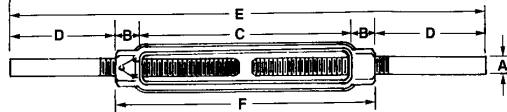

Turnbuckles Meet Performance Requirements of ASTM Specification F1145-92 Type 1 Grade 1 (Supercedes FF-T-791B)

Diameter & Take Up Dimensions A x C	Body Only- Drill & Tapped				Body and Stubs			Working Load Limit In Lbs.	
	Drilled & Tapped	Overall Length (F)	Weight per 100 D&T	Galvanized Part No.	Dimensions - Inches				Weight per 100
	Plain Part No.				B	D	E		
1/4" x 4"	25N400TBO	4-13/16"	14	25N400TBOG	13/32"	2-5/8"	10"	25	500
5/16" x 4-1/2"	31N450TBO	5-9/16"	21.5	31N450TBOG	1-7/32"	2-25/32"	11"	42.5	800
3/8" x 6"	37N600TBO	7-1/8"	37.5	37N600TBOG	9/16"	4-7/16"	16"	85	1200
1/2" x 2"	50N200TBO	3-1/2"	34	50N200TBOG	3/4"	3-1/4"	10-1/4"	84	2200
1/2" x 6"	50N600TBO	7-1/2"	66	50N600TBOG	3/4"	4-1/4"	16"	142.5	2200
1/2" x 9"	50N700TBO	10-1/2"	84.5	50N900TBOG	3/4"	4-1/4"	19"	170	2200
1/2" x 12"	50N1200TBO	13-1/2"	102	50N1200TBOG	3/4"	4-1/4"	22"	200	2200
5/8" x 6"	62N600TBO	7-7/8"	90.5	62N600TBOG	15/16"	4-1/16"	16"	212.5	3500
5/8" x 9"	62N700TBO	10-7/8"	131	62N900TBOG	15/16"	4-1/16"	19"	285	3500
5/8" x 12"	62N1200TBO	13-7/8"	172.5	62N1200TBOG	15/16"	4-1/16"	22"	317.5	3500
5/8" x 18"	62N1800TBO	20-1/4"	345	62N1800TBOG	15/16"	4-1/16"	28"	577.5	3500
3/4" x 6"	75N600TBO	8-1/4"	129	75N600TBOG	1-1/8"	4-3/8"	17"	320	5200
3/4" x 9"	75N900TBO	11-1/4"	191	75N900TBOG	1-1/8"	4-3/8"	20"	412.5	5200
3/4" x 12"	75N1200TBO	14-1/4"	243	75N1200TBOG	1-1/8"	4-3/8"	23"	497.5	5200
3/4" x 18"	75N1800TBO	20-1/4"	336.5	75N1800TBOG	1-1/8"	4-3/8"	29"	677.5	5200
7/8" x 6"	87N600TBO	8-5/8"	196	87N600TBOG	1-5/16"	4-11/16"	18"	467.5	7200
7/8" x 12"	87N1200TBO	14-5/8"	309.5	87N1200TBOG	1-5/16"	4-11/16"	24"	661	7200
7/8" x 18"	87N1800TBO	20-5/8"	583.5	87N1800TBOG	1-5/16"	4-11/16"	30"	1039	7200
1" x 6"	100N600TBO	9"	279	100N600TBOG	1-1/2"	5"	19"	610	9800
1" x 12"	100N1200TBO	15"	383	100N1200TBOG	1-1/2"	5"	25"	920	9800
1" x 18"	100N1800TBO	21"	566	100N1800TBOG	1-1/2"	5"	31"	1176.5	9800
1-1/8" x 6"	112N600TBO	9"	228	112N600TBOG	1-11/16"	4-5/8"	19"	693	11500
1-1/8" x 12"	112N1200TBO	15"	467.5	112N1200TBOG	1-11/16"	4-5/8"	25"	1017.5	11500
1-1/4" x 6"	125N600TBO	9-3/4"	449	125N600TBOG	1-7/8"	5-1/8"	20"	1093	14800
1-3/8" x 6"	137N600TBO	9-3/4"	430	137N600TBOG	2-3/16"	5-1/2"	20-1/2"	1195	17500
1-1/2" x 6"	150N600TBO	10-3/8"	684	150N600TBOG	2-3/16"	5-1/2"	20-1/2"	1580	21000

Larger sizes available. Please call for more info.

Maximum load ratings are based on a straight vertical lift in a gradually increasing manner. Any deviations as angular lifts, shock loads, modification of the basic part, etc., will result in drastically reduced maximum loads.

Drop Forged Yoke Ends Self-Colored Drop Forged Yoke Ends

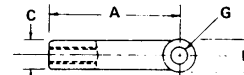
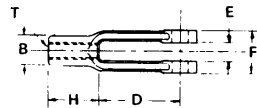
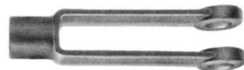

Adjustable

Part No.	"T" Tap Size	Dimensions In Inches - Machined									Est. Wt. Per. 100 Pcs.
		A	B	C	D	E	F	G	H	K	
/NO.51YOKEEND	1/4"-28	2"	7/16"	7/16"	1-1/4"	9/32"	5/8"	1/4"	3/4"	1/2"	7.5 Lbs.
/NO.52YOKEEND	5/16"-24	2-1/4"	1/2"	1/2"	1-7/16"	11/32"	3/4"	5/16"	13/16"	19/32"	10.7 Lbs.
/NO.53YOKEEND	3/8"-24	2-1/2"	5/8"	5/8"	1-5/8"	7/16"	7/8"	3/8"	7/8"	11/16"	16 Lbs.
/NO.54YOKEEND	7/16"-20	2-7/8"	23/32"	23/32"	1-7/8"	1/2"	1"	7/16"	1"	13/16"	24 Lbs.
/NO.55YOKEEND	1/2"-20	3"	13/16"	13/16"	1-7/8"	9/16"	1-1/8"	1/2"	1-1/8"	15/16"	32.2 Lbs.
/NO.56YOKEEND	5/8"-18	4-15/16"	1-1/16"	1-1/16"	3-11/16"	11/16"	1-3/8"	5/8"	1-1/4"	1-3/16"	80 Lbs.
/NO.57YOKEEND	3/4"-16	6-1/16"	1-1/4"	1-1/4"	4-9/16"	13/16"	1-5/8"	3/4"	1-1/2"	1-7/16"	135 Lbs.



Drop Forged Turnbuckles

Turnbuckles Meet Performance Requirements of ASTM Specification F1145-92 Type 1 Grade 1 (Supercedes FF-T-791B).

Available with hot galvanized or self-colored finish.



(Class D)



(Class D)

Diameter & Take Up	Eye and Eye			Hook and Hook			Weight per 100 in Lbs.
	Part No.		Closed Length	Part No.		Closed Length	
	SC	Galv.		SC	Galv.		
1/4" x 4"	25N400TEE	25N400TEEG	8"	25N400THH	25N400THHG	8-1/2"	35
5/16" x 4-1/2"	31N450TEE	31N450TEEG	9"	31N450THH	31N450THHG	9-1/2"	47.5
3/8" x 6"	37N600TEE	37N600TEEG	11-1/2"	37N600THH	37N600THHG	12"	90.6
1/2" x 2"	50N200TEE	50N200TEEG	8-1/2"	50N200THH	50N200THHG	10"	111
1/2" x 6"	50N600TEE	50N600TEEG	13"	50N600THH	50N600THHG	14-1/4"	170
1/2" x 9"	50N800TEE	50N900TEEG	16"	50N900THH	50N900THHG	17-1/4"	202
1/2" x 12"	50N1200TEE	50N1200TEEG	19"	50N1200THH	50N1200THHG	20-1/4"	232.5
5/8" x 6"	62N600TEE	62N600TEEG	13-1/2"	62N600THH	62N600THHG	14-3/4"	260
5/8" x 9"	62N900TEE	62N900TEEG	17"	62N900THH	62N900THHG	17-3/4"	320
5/8" x 12"	62N1200TEE	62N1200TEEG	20-1/2"	62N1200THH	62N1200THHG	20-3/4"	392.5
5/8" x 18"	62N1800TEE	62N1800TEEG	26-1/2"	62N1800THH	62N1800THHG	26-3/4"	557
3/4" x 6"	75N600TEE	75N600TEEG	14-3/4"	75N600THH	75N600THHG	16-3/4"	397.5
3/4" x 9"	75N900TEE	75N900TEEG	18"	75N900THH	75N900THHG	19-3/4"	512.5
3/4" x 12"	75N1200TEE	75N1200TEEG	21-3/4"	75N1200THH	75N1200THHG	22-3/4"	581
3/4" x 18"	75N1800TEE	75N1800TEEG	27-3/4"	75N1800THH	75N1800THHG	28-3/4"	666
7/8" x 6"	87N600TEE	87N600TEEG	18"	87N600THH	87N600THHG	19"	650
7/8" x 12"	87N1200TEE	87N1200TEEG	22-1/2"	87N1200THH	87N1200THHG	23-3/4"	787.5
7/8" x 18"	87N1800TEE	87N1800TEEG	28-1/2"	87N1800THH	87N1800THHG	29-3/4"	1212
1" x 6"	100N600TEE	100N600TEEG	17"	100N600THH	100N600THHG	20"	805
1" x 12"	100N1200TEE	100N1200TEEG	25"	100N1200THH	100N1200THHG	25-1/2"	1077.5
1" x 18"	100N1800TEE	100N1800TEEG	31"	100N1800THH	100N1800THHG	31-1/2"	1386

To ascertain extended length add amount of take-up to length in closed position. Eye, Jaw and Hook fittings are heat treated.



(Class E)



(Class E)

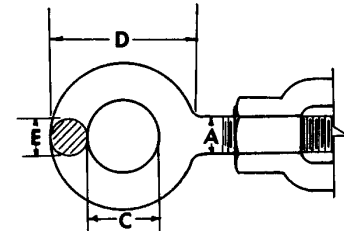
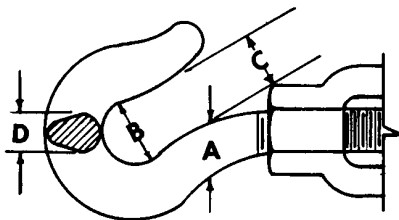

Hook

Dimensions - Inches				Working Load Limit In Lbs.†
A	B	C	D	
1/4"	5/16"	9/32"	7/32"	400
5/16"	1/2"	1/2"	5/16"	700
3/8"	1/2"	1/2"	3/8"	1,000
1/2"	7/8"	13/16"	17/32"	1,500
5/8"	29/32"	27/32"	5/8"	2,250
3/4"	1-1/8"	29/32"	11/16"	3,000
7/8"	1-3/16"	1-1/16"	13/16"	3,200
1"	1-3/8"	1-1/4"	7/8"	5,000

Eye

Dimensions - Inches				Working Load Limit In Lbs.†
A	C	D	E	
1/4"	1/2"	1"	7/32"	500
5/16"	5/8"	1-1/4"	9/32"	800
3/8"	3/4"	1-1/2"	11/32"	1,200
1/2"	1"	2"	17/16"	2,200
5/8"	1-1/4"	2-5/16"	17/32"	3,500
3/4"	1-1/2"	2-3/4"	5/8"	5,200
7/8"	1-3/4"	3-1/2"	7/8"	7,200
1"	2"	3-3/4"	7/8"	10,000

† Loads are based on a safety factor of 5 to 1. Maximum load ratings are based on a straight vertical lift in a gradually increasing manner. Any deviations as angular lifts, shock loads, modification of the basic part, etc., will result in drastically reduced maximum loads.

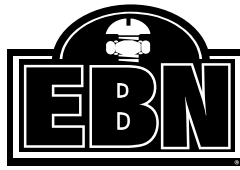

Drop Forged Turnbuckles

Turnbuckles Meet Performance Requirements of ASTM Specification F1145-92 Type 1 Grade 1 (Supersedes FF-T-791B).



(Class F)

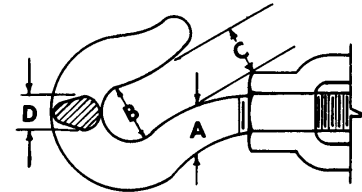

Hook Dimensions - Strength

Dimensions - Inches				Working Load Limit In Lbs.†
A	B	C	D	
1/4"	5/16"	9/32"	7/32"	400
5/16"	1/2"	1/2"	5/16"	700
3/8"	1/2"	1/2"	3/8"	1,000
1/2"	7/8"	13/16"	17/32"	1,500
5/8"	29/32"	27/32"	5/8"	2,250
3/4"	1-1/8"	29/32"	11/16"	3,000
7/8"	1-3/16"	1-1/16"	13/16"	3,200
1"	1-3/8"	1-1/4"	7/8"	5,000

Available with hot galvanized or self-colored finish. Eye, Jaw and Hook fittings are heat treated

Diameter & Take Up	Hook and Eye		Closed Length	Weight Per 100 in Lbs.
	Part No.			
	SC	Galv.		
1/4" x 4"	25N400THE	25N400THEG	8-1/4"	35
5/16" x 4-1/2"	31N450THE	31N450THEG	9-1/4"	47.5
3/8" x 6"	37N600THE	37N600THEG	11-3/4"	90.6
1/2" x 2"	50N200THE	50N200THEG	9-1/4"	109
1/2" x 6"	50N600THE	50N600THEG	13-5/8"	170
1/2" x 9"	50N900THE	50N900THEG	16-3/8"	202
1/2" x 12"	50N1200THE	50N1200THEG	19-5/8"	232.5
5/8" x 6"	62N600THE	62N600THEG	14-1/8"	260
5/8" x 9"	62N900THE	62N900THEG	17-3/8"	320
5/8" x 12"	62N1200THE	62N1200THEG	20-5/8"	392.5
5/8" x 18"	62N1800THE	62N1800THEG	26-5/8"	557
3/4" x 6"	75N600THE	75N600THEG	15-3/4"	397.5
3/4" x 9"	75N900THE	75N900THEG	18-7/8"	512.5
3/4" x 12"	75N1200THE	75N1200THEG	22-1/8"	581
3/4" x 18"	75N1800THE	75N1800THEG	28-1/8"	666
7/8" x 6"	87N600THE	87N600THEG	18-1/2"	650
7/8" x 12"	87N1200THE	87N1200THEG	23-1/8"	787.5
7/8" x 18"	87N1800THE	87N1800THEG	29-1/8"	1212
1" x 6"	100N600THE	100N600THEG	19-1/2"	805
1" x 12"	100N1200THE	100N1200THEG	25-1/4"	1077.5
1" x 18"	100N1800THE	100N1800THEG	31-1/4"	1386

To ascertain extended length add amount of take-up to length in closed position.

† Loads are based on a safety factor of 5 to 1.

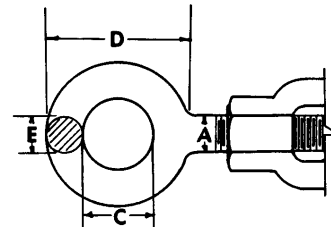

Eye Dimensions - Strength

Dimensions - Inches				Working Load Limit In Lbs.†
A	C	D	E	
1/4"	1/2"	1"	7/32"	500
5/16"	5/8"	1-1/4"	9/32"	800
3/8"	3/4"	1-1/2"	11/32"	1,200
1/2"	1"	2"	7/16"	2,200
5/8"	1-1/4"	2-5/16"	17/32"	3,500
3/4"	1-1/2"	2-3/4"	5/8"	5,200
7/8"	1-3/4"	3-1/2"	7/8"	7,200
1"	2"	3-3/4"	7/8"	10,000

† Loads are based on a safety factor of 5 to 1.

Maximum load ratings are based on a straight vertical lift in a gradually increasing manner. Any deviations as angular lifts, shock loads, modification of the basic part, etc., will result in drastically reduced maximum loads.



Drop Forged Turnbuckles

Turnbuckles Meet Performance Requirements of ASTM Specification F1145-92 Type 1 Grade 1 (Supercedes FF-T-791B).

Eye, Jaw and Hook fittings are heat treated

Diameter & Take Up	Jaw and Eye Hot Galvanized			Jaw and Jaw Hot Galvanized		
	Part No.	Closed Length.	Weight Per 100	Part No.	Closed Length	Weight Per 100
1/4" x 4"	25N400TJEG	8-1/4"	37.5	25N400TJGG	8-1/2"	40
5/16" x 4-1/2"	31N450TJEG	9-1/8"	52.5	31N450TJGG	9-1/4"	52.5
3/8" x 6"	37N600TJEG	11-1/2"	96.5	37N600TJGG	11-1/2"	97.5
1/2" x 2"	50N200TJEG	8-3/4"	109	50N200TJGG	8-7/8"	119
1/2" x 6"	50N600TJEG	13-1/4"	160	50N600TJGG	13-1/2"	170
1/2" x 9"	50N900TJEG	16-1/4"	198.5	50N900TJGG	16-1/2"	202.5
1/2" x 12"	50N1200TJEG	19-1/4"	225	50N1200TJGG	19-1/2"	227.5
5/8" x 6"	62N600TJEG	14-5/8"	257.5	62N600TJGG	15-3/4"	260.5
5/8" x 9"	62N900TJEG	17-7/8"	330	62N900TJGG	18-3/4"	330
5/8" x 12"	62N1200TJEG	21-1/8"	402	62N1200TJGG	21-3/4"	407
5/8" x 18"	62N1800TJEG	27-1/8"	581	62N1800TJGG	27-3/4"	607
3/4" x 6"	75N600TJEG	15-5/8"	402.5	75N600TJGG	16-1/2"	417.5
3/4" x 9"	75N900TJEG	18-3/4"	522.5	75N900TJGG	19-1/2"	545
3/4" x 12"	75N1200TJEG	22"	602.5	75N1200TJGG	22-1/2"	619.5
3/4" x 18"	75N1800TJEG	28"	702	75N1800TJGG	28-1/2"	753
7/8" x 6"	87N600TJEG	19"	655	87N600TJGG	19-1/2"	668
7/8" x 12"	87N1200TJEG	23-1/2"	842.5	87N1200TJGG	24-1/2"	862.5
7/8" x 18"	87N1800TJEG	29-1/2"	1252	87N1800TJGG	30-1/2"	1281
1" x 6"	100N600TJEG	19-1/8"	872	100N600TJGG	21-3/16"	911
1" x 12"	100N1200TJEG	25-1/4"	1137.5	100N1200TJGG	25-1/2"	1165
1" x 18"	100N1800TJEG	31-1/4"	1463	100N1800TJGG	31-1/2"	1518



(Class H)



(Class G)

Available with hot galvanized or self-colored finish. Jaw types supplied with round pins and cotter keys unless nuts and bolts are specified. Locking nuts are also available.



Diameter & Take Up	Rod End Eye & Eye			
	Self-Colored Part No.	Hot Galvanized Part No.	Closed Length	Weight per 100
1/2" x 6"	50N600TEE	50N600TEEG	13"	131
5/8" x 6"	62N600TEE	62N600TEEG	13-1/4"	205
3/4" x 6"	75N600TEE	75N600TEEG	13-1/2"	293
7/8" x 6"	87N600TEE	87N600TEEG	14"	456
1" x 6"	100N600TEE	100N600TEEG	14-1/8"	589

Jaw Dimensions - Strength

Dimensions - Inches								Working Load Limit In Lbs.†
A	B	C	D	*E	F	**H	P	
1/4"	7/32"	5/16"	25/32"	3/8"	5/8"	9/32"	1/4"	500
5/16"	1/4"	5/16"	7/8"	15/32"	5/8"	9/32"	1/4"	800
3/8"	9/32"	13/32"	1"	1/2"	13/16"	11/32"	5/16"	1,200
1/2"	5/16"	1/2"	1-9/32"	5/8"	1"	15/32"	7/16"	2,200
5/8"	3/8"	21/32"	1-21/32"	7/8"	1-5/16"	35/64"	1/2"	3,500
3/4"	1/2"	13/16"	1-27/32"	15/16"	1-5/8"	43/64"	5/8"	5,200
7/8"	9/16"	29/32"	1-31/32"	1-5/32"	1-7/8"	25/32"	3/4"	7,200
1"	11/16"	1-1/16"	2-13/32"	1-3/16"	2"	15/16"	7/8"	10,000

* At parting line: includes 7° draft

**Hole Size

† Loads are based on a safety factor of 5 to 1.

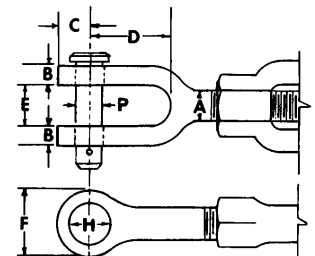

Also Available: Midget Turnbuckles



Eye & Eye



Hook & Eye



Hook & Hook

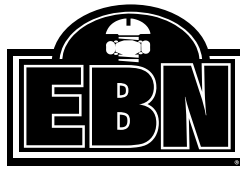

Drop Forged Anchor Shackles

Size, working load limit, and trademark are permanently marked on all shackles. All shackles and pins are heat treated. Loads are based on a safety factor of 6 to 1, except (**) which is 5 to 1. When tested all shackles are pulled at a uniform rate of speed in a direct tension.

Shackles Meet Performance Requirements of Federal Specifications RR-C-271D Type IVA*

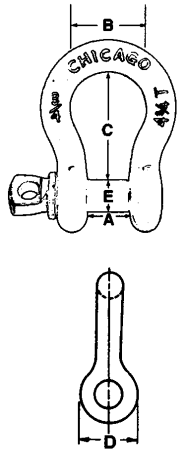

Working Load Limit In Tons	Anchor - Round Pin - Screw Pin - Safety								Estimated Weight Per 100 In Lbs.
	Dimensions Inches						O.D. Eyes (D)	Pin Or Bolt Dia. (E)	
	Size Dia.	Width @ Eyes (A)	Tol. ±	Width @ Bow (B)	Length (C)	Tol. ±			
1/3	3/16"	3/8"	1/16"	9/16"	7/8"	1/16"	5/8"	1/4"	7
1/2	1/4"	15/32"	1/16"	3/4"	1-1/8"	1/16"	3/4"	5/16"	13.5
3/4	5/16"	17/32"	1/16"	15/16"	1-1/4"	1/16"	7/8"	3/8"	22
1	3/8"	21/32"	1/16"	1-1/8"	1-7/16"	1/8"	1"	7/16"	33
1-1/2	7/16"	23/32"	1/16"	1-5/16"	1-11/16"	1/8"	1-1/8"	1/2"	53.5
2	1/2"	13/16"	1/16"	1-1/2"	1-15/16"	1/8"	1-1/4"	5/8"	76.5
3-1/4	5/8"	1-1/16"	1/16"	1-7/8"	2-1/2"	1/8"	1-11/16"	3/4"	150.5
4-3/4	3/4"	1-1/4"	1/16"	2"	3"	1/4"	1-7/8"	7/8"	245.5
6-1/2	7/8"	1-7/16"	1/16"	5-5/8"	3-1/4"	1/4"	2-1/8"	1"	375
8-1/2	1"	1-11/16"	1/16"	2-3/4"	3-3/4"	1/4"	2-1/2"	1-1/8"	537.5
9-1/2	1-1/8"	1-13/16"	1/16"	2-15/16"	4-1/4"	1/4"	2-5/8"	1-1/4"	765
12	1-1/4"	2"	1/16"	3-1/4"	4-1/2"	1/4"	3"	1-3/8"	1007.5
13-1/2	**1-3/8"	2-1/4"	1/8"	3-1/2"	5-1/4"	1/4"	3-1/4"	1-1/2"	1232.5
17	1-1/2"	2-3/8"	1/8"	3-3/4"	5-3/4"	1/4"	3-1/2"	1-5/8"	1777.5

WARNING

Any deviations such as angular lifts, shock loads, modification of the basic forging, etc., will result in drastically reduced working load limits.

All types of shackles are available in a self-colored or hot galvanized finish. When ordering specify the size, finish, and type of shackle. Other rust preventative coatings are available on a special basis. Safety shackles are of the same specifications as the regular types except for the bolt, nut and cotter.

*Class 2



Screw Pin

Size	Galvanized Part No.
3/16"	18NSSPG
1/4"	25NSSPG
5/16"	31NSSPG
3/8"	37NSSPG
7/16"	43NSSPG
1/2"	50NSSPG
5/8"	62NSSPG
3/4"	75NSSPG
7/8"	87NSSPG
1"	100NSSPG
1-1/8"	112NSSPG
1-1/4"	125NSSPG
1-3/8"	137NSSPG
1-1/2"	150NSSPG

Also Available:

*Class 1



Round Pin

*Class 3



Safety

Other sizes & types available.
 Please call.

Evansville, IN
Jasper, IN
Vincennes, IN

812-477-0077
812-482-5105
812-882-4090



Henderson, KY
Owensboro, KY
Mt. Vernon, IL
270-830-0077
270-684-0877
618-244-7156

Wire Rope



Part No.	Size	Length Per Reel	Strand	Finish	Minimum Breaking Strength (Lbs.)	Approx. Weight per 100 ft. (Lbs.)
/ORG0110395	1/8	500'	7 x 7	Electro-Galvanized	1,700	2.8
/12ACCABLES	1/8	500'	7 x 7	Stainless Steel	1,700	2.8
/ORG0110395	3/16	250'	7 x 19	Electro-Galvanized	4,200	6.5
/18ACCABLES	3/16	250'	7 x 19	Stainless Steel	3,700	6.5
/ORG0110395	1/4	250'	7 x 19	Electro-Galvanized	7,000	11.0
/25ACCABLES	1/4	250'	7 x 19	Stainless Steel	6,400	11.0
/ORG0110395	5/16	200'	7 x 19	Electro-Galvanized	9,800	17.3
/31ACCABLES	5/16	200'	7 x 19	Stainless Steel	9,000	17.3
/ORG0110395	3/8	200'	7 x 19	Electro-Galvanized	14,400	24.3
/37ACCABLES	3/8	200'	7 x 19	Stainless Steel	12,000	24.3

NOTE: Not for aircraft use but suitable for industrial, utility, and marine applications.

Listed for comparison only.

Actual operating loads may vary, but should never exceed the recommended design factor or 20% of the Minimum Breaking Strength.

Uncoated cable according to Federal Specification RR-W-410D.

Uncoated cable meets dimensional and strength requirements of MIL-W-83420D.

**Other Sizes, Strands, or Coatings
Available Along With Hardware.**

If needed, please inquire at EBN.

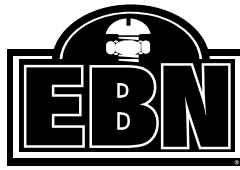

Drop Forged Wire Rope Clips

Component parts are galvanized. U-bolts, with or without nuts, price on application.

Should be used in heavy-duty applications

Rope Size	Hot Dipped Galvanized Part No.	U-Bolt Dimensions				Weight Per 100
		A	B	C	T	
1/8"	12RCWRG/DF	1/2"-24	3/4"	9/32"	1/2"	6.5
3/16"	18RCWRG/DF	1/4"-20	15/16"	5/16"	5/8"	10
1/4"	25RCWRG/DF	5/16"-18	1-5/32"	3/8"	3/4"	18.5
5/16"	31RCWRG/DF	3/8"-16	1-1/2"	1/2"	1"	29.5
3/8"	37RCWRG/DF	7/16"-14	1-5/8"	9/16"	7/8"	44
7/16"	43RCWRG/DF	1/2"-13	1-7/8"	5/8"	1-1/4"	64
1/2"	50RCWRG/DF	1/2"-13	1-7/8"	5/8"	1-1/4"	75
9/16"	56RCWRG/DF	9/16"-12	2-3/8"	3/4"	1-3/8"	106
5/8"	62RCWRG/DF	9/16"-12	2-3/8"	3/4"	1-3/8"	106
3/4"	75RCWRG/DF	5/8"-11	2-3/4"	7/8"	1-5/8"	153
7/8"	87RCWRG/DF	3/4"-10	3-1/4"	1"	1-7/8"	237.5
1"	100RCWRG/DF	3/4"-10	3-5/8"	1-1/8"	2"	272.5
1-1/8"	112RCWRG/DF	3/4"-10	3-13/16"	1-1/4"	2-1/4"	325
1-1/4"	125RCWRG/DF	7/8"-9	4-3/8"	1-11/32"	2-1/2"	441
1-1/2"	150RCWRG/DF	7/8"-9	5-1/8"	1-11/16"	2-3/4"	550

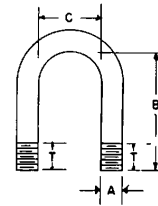

Meets Performance Requirements of Federal Specification FF-C-450, Type 1, Class 1

1



2



3



RECOMMENDED APPLICATION FOR DROP FORGED WIRE ROPE CLIPS

Clip Size Inches	Minimum No. of Clips	Amount of Rope to Turn Back In Inches	Torque In Ft. (lbs.)
1/8"	2	3-1/4"	4.5
3/16"	2	3-3/4"	7.5
1/4"	2	4-3/4"	15
5/16"	2	5-1/4"	30
3/8"	2	6-1/2"	45
7/16"	2	7"	65
1/2"	3	11-1/2"	65
9/16"	3	12"	95
5/8"	3	12"	95
3/4"	4	18"	130
7/8"	4	19"	225
1"	5	26"	225
1-1/8"	6	34"	225
1-1/4"	7	44"	360
1-1/2"	8	54"	360

1. The correct way to attach wire rope clips is illustrated above. Apply the first clip one base width from the dead end of the wire rope. The base or saddle should bear on the line end of the rope -U-bolt on the short end. Tighten nuts firmly.

2. Attach second clip as close to loop as possible. Tighten nuts but not firmly.

3. Attach balance of clips spaced equally between first two clips.. Tighten all nuts completely. Apply initial load - inspect nuts and retighten. Inspect all clips periodically.

The number of clips shown is based on using right regular or Lang lay wire rope, 6x19 class or 6x37 class, fibre core IWRC, IPS, or XIPS. The number of clips shown also applies to right regular lay wire rope, 8x19 class and 18x7 class, fibre core, IPS or XIPS, sizes 1-1/2-inch and smaller.

If Seale construction or similar large outer wire type construction in the 6x19 class is to be used for sizes 1-inch and larger, add one additional clip. For other classes or wire rope not mentioned, it may be necessary to add additional clips to the number shown. If more clips are used than shown, amount of rope turn back should be increased proportionately.

Also Available: Wire Rope Thimbles



Drop Forged Eye Bolts

Regular, shoulder and screw thread drop forged heat treated steel eye bolts supplied as standard with hot galvanized finish. Machine thread eye bolts are threaded National Course before galvanizing and assembled with hex nuts tapped oversize. Loads are based on a safety factor of 5 to 1. When tested all eye bolts are pulled at a uniform rate of speed in a direct tension.

Regular - Machine Thread

Diameter (A) & Shank Length (B)	Part No.	Dimensions - Inches				Weight Per 100 pcs.	Working Load Limit
		Outside Eye (C)	Inside Eye (D)	Overall Length (E)	Thread Length (T)		
1/4" x 2"	25C200EBPG/NUT	1"	1/2"	3"	1-1/2"	6.4	500
1/4" x 3"	25C300EBPG/NUT	1"	1/2"	4"	1-1/2"	8	500
1/4" x 4"	25C400EBPG/NUT	1"	1/2"	5"	2"	9.3	500
1/4" x 5"	25C500EBPG/NUT	1"	1/2"	6"	2-1/2"	10.4	500
1/4" x 6"	25C600EBPG/NUT	1"	1/2"	7"	3"	11.8	500
5/16" x 2-1/4"	31C225EBPG/NUT	1-1/4"	5/8"	3-1/2"	1-1/2"	12.7	800
5/16" x 3-1/4"	31C325EBPG/NUT	1-1/4"	5/8"	4-1/2"	1-1/2"	15	800
5/16" x 4-1/4"	31C425EBPG/NUT	1-1/4"	5/8"	5-1/2"	2-1/2"	16.5	800
5/16" x 5"	31C500EBPG/NUT	1-1/4"	5/8"	6-1/4"	2-1/2"	18.6	800
5/16" x 6"	31C600EBPG/NUT	1-1/4"	5/8"	7-1/4"	3"	24.5	800
3/8" x 2-1/2"	37C250EBPG/NUT	1-1/2"	3/4"	4"	1-1/2"	19.2	1200
3/8" x 3"	37C300EBPG/NUT	1-1/2"	3/4"	4-1/2"	1-1/2"	21.2	1200
3/8" x 4-1/4"	37C425EBPG/NUT	1-1/2"	3/4"	6"	2"	24.4	1200
3/8" x 5"	37C500EBPG/NUT	1-1/2"	3/4"	6-1/2"	2-1/2"	27.8	1200
3/8" x 6"	37C600EBPG/NUT	1-1/2"	3/4"	7-1/2"	3"	30	1200
3/8" x 8"	37C800EBPG/NUT	1-1/2"	3/4"	9-1/2"	4"	36	1200
1/2" x 2"	50C200EBPG/NUT	2"	1"	4"	1-7/8"	38.5	2200
1/2" x 3-1/4"	50C325EBPG/NUT	2"	1"	5-1/4"	1-1/2"	46	2200
1/2" x 4-1/2"	50C450EBPG/NUT	2"	1"	6-1/2"	2"	53	2200
1/2" x 6"	50C600EBPG/NUT	2"	1"	8"	3"	60	2200
1/2" x 8"	50C800EBPG/NUT	2"	1"	10"	4"	71	2200
1/2" x 10"	50C1000EBPG/NUT	2"	1"	12"	4"	83	2200
1/2" x 12"	50C1200EBPG/NUT	2"	1"	14"	4"	96	2200
5/8" x 4-1/2"	62C450EBPG/NUT	2-5/16"	1-1/4"	6-13/16"	2"	79	3500
5/8" x 6"	62C600EBPG/NUT	2-5/16"	1-1/4"	8-5/16"	3"	96	3500
5/8" x 8"	62C800EBPG/NUT	2-5/16"	1-1/4"	10-5/16"	4"	128	3500
5/8" x 10"	62C1000EBPG/NUT	2-5/16"	1-1/4"	12-5/16"	4"	129.5	3500
5/8" x 12"	62C1200EBPG/NUT	2-5/16"	1-1/4"	14-5/16"	4"	146	3500
5/8" x 15"	62C1500EBPG/NUT	2-5/16"	1-1/4"	17-5/16"	6"	168	3500
5/8" x 18"	62C1800EBPG/NUT	2-5/16"	1-1/4"	20-5/16"	6"	195	3500
5/8" x 24"	62C2400EBPG/NUT	2-5/16"	1-1/4"	26-5/16"	6"	246	3500
3/4" x 4-1/2"	75C450EBPG/NUT	2-3/4"	1-1/2"	7-1/4"	2-1/2"	126	5200
3/4" x 6"	75C600EBPG/NUT	2-3/4"	1-1/2"	8-3/4"	3"	160	5200
3/4" x 8"	75C800EBPG/NUT	2-3/4"	1-1/2"	10-3/4"	4"	180	5200
3/4" x 10"	75C1000EBPG/NUT	2-3/4"	1-1/2"	12-3/4"	4"	200	5200
3/4" x 12"	75C1200EBPG/NUT	2-3/4"	1-1/2"	14-3/4"	4"	233	5200
3/4" x 15"	75C1500EBPG/NUT	2-3/4"	1-1/2"	17-3/4"	6"	254	5200
3/4" x 18"	75C1800EBPG/NUT	2-3/4"	1-1/2"	20-3/4"	6"	290	5200
3/4" x 24"	75C2400EBPG/NUT	2-3/4"	1-1/2"	26-3/4"	6"	369	5200
7/8" x 5"	87C500EBPG/NUT	3-1/2"	1-3/4"	8-1/2"	2-1/2"	245	7000
7/8" x 8"	87C800EBPG/NUT	3-1/2"	1-3/4"	11-1/2"	4"	296	7000
7/8" x 12"	87C1200EBPG/NUT	3-1/2"	1-3/4"	15-1/2"	4"	366	7000
7/8" x 18"	87C1800EBPG/NUT	3-1/2"	1-3/4"	21-1/2"	6"	464	7000
7/8" x 24"	87C2400EBPG/NUT	3-1/2"	1-3/4"	27-1/2"	6"	556	7000
1" x 6"	100C600EBPG/NUT	3-3/4"	2"	9-3/4"	3"	301	10000
1" x 9"	100C900EBPG/NUT	3-3/4"	2"	12-3/4"	4"	383	10000
1" x 12"	100C1200EBPG/NUT	3-3/4"	2"	15-3/4"	4"	450	10000
1" x 18"	100C1800EBPG/NUT	3-3/4"	2"	21-3/4"	6"	584	10000
1" x 24"	100C2400EBPG/NUT	3-3/4"	2"	27-3/4"	6"	716	10000

WARNING

Any deviations such as angular lifts, shock loads, modification of the basic forging, etc., will result in drastically reduced working load limits.

Special shank and thread lengths are also available.

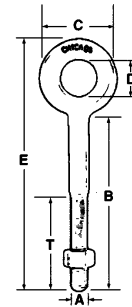

Some sizes Also available in Stainless Steel.



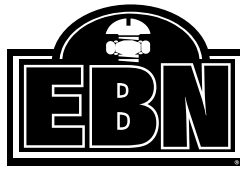

Machinery Eye Bolts

Maximum blank lengths, either pattern indicated in column (1). Vertical loads are based on a safety factor of 5 to 1. Variation in quantity: on special items we reserve the right to a maximum 10% variation for allowances in manufacture.

Standard Shank Lengths - Plain & Shoulder Pattern

Part Numbers		Dimensions - Inches						
Plain Pattern	Shoulder Pattern	Shank		Eye		Overall Length Plain	Overall Length Shoulder	Maximum Lengths (1)
		Die & Thread	Length	I.D.	O.D.			
25C100EBP	25C100EBS	1/4"-20	1"	3/4"	1-1/4"	2-1/4"	2-3/8"	3"
31C112EBP	31C112EBS	5/16"-18	1-1/8"	7/8"	1-1/2"	2-5/8"	2-3/4"	4"
37C125EBP	37C125EBS	3/8"-16	1-1/4"	1"	1-21/32"	2-29/32"	3-1/4"	4-1/2"
43C137EBP	43C137EBS	7/16"-14	1-3/8"	1-3/32"	1-27/32"	3-7/32"	3-5/8"	4-1/2"
50C150EBP	50C150EBS	1/2"-13	1-1/2"	1-3/16"	2-1/16"	3-9/16"	4"	4-1/2"
56C162EBP	56C162EBS	9/16"-12	1-5/8"	1-9/32"	2-9/32"	3-29/32"	4-1/2"	4-1/2"
62C175EBP	62C175EBS	5/8"-11	1-3/4"	1-3/8"	2-1/2"	4-1/4"	4-7/8"	4-1/2"
75C200EBP	75C200EBS	3/4"-10	2"	1-1/2"	2-13/16"	4-13/16"	5-1/4"	5"
87C225EBP	87C225EBS	7/8"-9	2-1/4"	1-11/16"	3-1/4"	5-1/2"	6"	5"
100C250EBP	100C250EBS	1"-8	2-1/2"	1-13/16"	3-9/16"	6-1/16"	7"	5"
112C275EBP	112C275EBS	1-1/8"-7	2-3/4"	2"	4"	6-3/4"	7-1/2"	2-3/4"
125C300EBP	125C300EBS	1-1/4"-7	3"	2-3/16"	4-7/16"	7-7/16"	8-1/2"	3"
150C350EBP	150C350EBS	1-1/2"-6	3-1/2"	2-1/2"	5-3/16"	8-11/16"	9-1/2"	3-1/2"

Working load limits for eye bolts are based on a straight vertical lift in a gradually increasing manner. Angular lifts will significantly lower working load limits (see Shoulder Pattern) and should be avoided whenever possible. If an angular lift is required, a properly seated Shoulder Pattern eye bolt must be used. Loads should always be applied to eye bolts in the plane of the eye, not at some angle to this plane. Angular lifts must never be more than a 45° pull.

Diameter and Thread	Working Load Limit	
	Straight Pull (x)	45° Pull (Y) Shoulder
1/4"-20	500	125
5/16"-18	900	225
3/8"-16	1400	350
7/16"-14	2000	500
1/2"-13	2600	650
9/16"-12	3200	750
5/8"-11	4000	1000
3/4"-10	6000	1500
7/8"-9	7000	1750
1"-8	9000	2250
1-1/8"-7	12000	2500
1-1/4"-7	15000	3750
1-1/2"-6	21000	4900

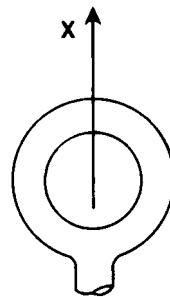

Plain Pattern

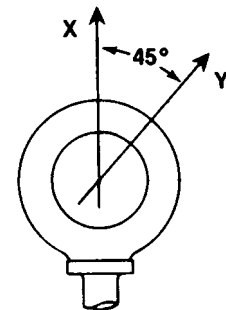

Shoulder Pattern

Angular Lifts Should Be Avoided Whenever Possible

Evansville, IN
Jasper, IN
Vincennes, IN

812-477-0077
812-482-5105
812-882-4090



Henderson, KY
Owensboro, KY
Mt. Vernon, IL

270-830-0077
270-684-0877
618-244-7156



Machinery Eye Bolts

Variation in quantity: on special items we reserve the right to a maximum 10% variation for allowances in manufacture.

Special Shank Lengths Plain Pattern



Bolt Diameter N.C.	Special Shank Length	Threaded	
		Part No.	Weight Per 100
1/4"	2"	25C200EBP	6
1/4"	3"	25C300EBP	10
5/16"	2"	31C200EBP	12
5/16"	3"	31C300EBP	14
5/16"	4"	31C400EBP	14
3/8"	2"	37C200EBP	16
3/8"	3"	37C300EBP	18
3/8"	4"	37C400EBP	22
3/8"	4-1/2"	37C450EBP	22
7/16"	2"	43C200EBP	22
7/16"	3"	43C300EBP	26
7/16"	4"	43C400EBP	30
7/16"	4-1/2"	43C450EBP	30
1/2"	2"	50C200EBP	32
1/2"	3"	50C300EBP	38
1/2"	4"	50C400EBP	42
1/2"	4-1/2"	50C450EBP	42
9/16"	2"	56C200EBP	48
9/16"	3"	56C300EBP	54
9/16"	4"	56C400EBP	60
9/16"	4-1/2"	56C450EBP	60
5/8"	2"	62C200EBP	62
5/8"	3"	62C300EBP	70
5/8"	4"	62C400EBP	74
5/8"	4-1/2"	62C450EBP	769
3/4"	3"	75C300EBP	96
3/4"	4"	75C400EBP	104
3/4"	4-1/2"	75C450EBP	108
3/4"	5"	75C500EBP	132
7/8"	3"	87C300EBP	188
7/8"	4"	87C400EBP	202
7/8"	4-1/2"	87C450EBP	210
7/8"	5"	87C500EBP	218
1"	3"	100C300EBP	210
1"	4"	100C400EBP	230
1"	4-1/2"	100C450EBP	236
1"	5"	100C500EBP	254

Special Shank Lengths Shoulder Pattern



Bolt Diameter N.C.	Special Shank Length	Threaded	
		Part No.	Weight Per 100
1/4"	2"	25C200EBS	8
1/4"	3"	25C300EBS	10
5/16"	2"	31C200EBS	12
5/16"	3"	31C300EBS	14
5/16"	4"	31C400EBS	16
3/8"	2"	37C200EBS	20
3/8"	3"	37C300EBS	22
3/8"	4"	37C400EBS	24
3/8"	4-1/2"	37C450EBS	26
7/16"	2"	43C200EBS	26
7/16"	3"	43C300EBS	30
7/16"	4"	43C400EBS	34
7/16"	4-1/2"	43C450EBS	36
1/2"	2"	50C200EBS	40
1/2"	3"	50C300EBS	44
1/2"	4"	50C400EBS	46
1/2"	4-1/2"	50C450EBS	48
9/16"	2"	56C200EBS	48
9/16"	3"	56C300EBS	52
9/16"	4"	56C400EBS	58
9/16"	4-1/2"	56C450EBS	60
5/8"	2"	62C200EBS	74
5/8"	3"	62C300EBS	82
5/8"	4"	62C400EBS	90
5/8"	4-1/2"	62C450EBS	92
3/4"	3"	75C300EBS	116
3/4"	4"	75C400EBS	130
3/4"	4-1/2"	75C450EBS	132
3/4"	5"	75C500EBS	138
7/8"	3"	87C300EBS	186
7/8"	4"	87C400EBS	202
7/8"	4-1/2"	87C450EBS	208
7/8"	5"	87C500EBS	216
1"	3"	100C300EBS	254
1"	4"	100C400EBS	266
1"	4-1/2"	100C450EBS	280
1"	5"	100C500EBS	290

Metric Machinery Eye Bolts

Dimensions In Millimeters - Some Sizes Available In Stainless Steel On A Special Basis
Forged • Carbon Steel • Self-Colored • Shoulder Pattern

Part No.	Metric Size	Approx. Equivalent In Inches	A Thread Size	B Shank Length, mm	C I.D. Eye, mm	Approx. Wt. Per 100 Pcs. In. Lbs.	Working Load Limit In Kgs.	Working Load Limit In Lbs.
.6C25EBS	M6	1/4"	M6 x 1.0	25.4	19	6	210	462
.7C28EBS	M7	5/16"	M7 x 1.0	28.5	22	10	370	814
.8C32EBS	M8	3/8"	M8 x 1.25	31.7	25	16	450	992
.10C35EBS	M10	7/16"	M10 x 1.5	35.0	28	21	740	1,628
.12C38EBS	M12	1/2"	M12 x 1.75	38.0	30	38	1,030	2,266
.14C45EBS	M14	9/16"	M14 x 2.0	44.5	35	73	1,600	3,520
.16C45EBS	M16	5/8"	M16 x 2.0	44.5	35	73	1,600	3,520
.18C51EBS	M18	3/4"	M18 x 2.5	51.0	38	104	2,140	4,708
.20C57EBS	M20	7/8"	M20 x 2.5	57.0	43	161	2,860	6,292
.24C64EBS	M24	1"	M24 x 3.0	63.5	46	231	3,850	8,470
.27C70EBS	M27	1-1/8"	M27 x 3.0	70.0	51	335	5,200	11,440
.30C76EBS	M30	1-1/4"	M30 x 3.5	76.0	55	439	6,400	14,080
.36C89EBS	M36	1-1/2"	M36 x 4.0	89.0	63	731	8,970	19,734

Visit us on the WEB @ EBNinc.com



Alloy Steel Swivel Hoist Rings

EBN is proud to announce the addition of Center Pull Style Swivel Hoist Rings to its product line. This is the ideal product for angular lift applications. These Swivel Hoist Rings have full swivel and pivot action. Our hoist rings are alloy steel with a black oxide finish. They adhere to the same rigid quality standards that have been a part of EBN's proud tradition. Individually proof tested and magnetic particle inspected. From 800 to 24,000 lb. load capacities (Rated at 5:1 safety factor).

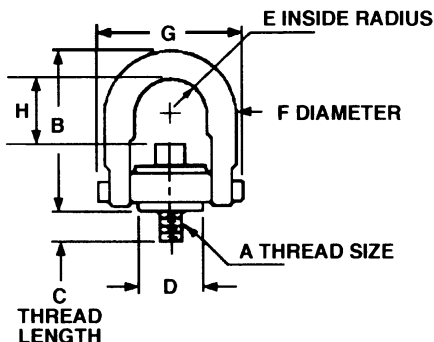

Part No.	Thread Size (A)	Working Load Limit	Thread Length (C)	B	D	E	F	G	H	Torque
/860048	5/16"-18	800	9/16"	2.67"	0.75"	0.43"	0.38"	1.84"	1-1/4"	7
/860079	3/8"-16	1000	9/16"	2.67"	0.75"	0.43"	0.38"	1.84"	1-1/4"	12
/860130	1/2"-13	2500	3/4"	4.78"	1.5"	0.88"	0.75"	3.52"	2-3/8"	28
/860161	1/2"-13	2500	1"	4.78"	1.5"	0.88"	0.75"	3.52"	2-3/8"	28
/860192	1/2"-13	2500	1-1/4"	4.78"	1.5"	0.88"	0.75"	3.52"	2-3/8"	28
/860222	5/8"-11	4000	1"	4.78"	1.5"	0.88"	0.75"	3.52"	2-1/4"	60
/860253	5/8"-11	4000	1-1/4"	4.78"	1.5"	0.88"	0.75"	3.52"	2-1/4"	60
/860284	3/4"-10	5000	1"	4.78"	1.5"	0.88"	0.75"	3.52"	2-1/8"	100
/860314	3/4"-10	5000	1-1/2"	4.78"	1.5"	0.88"	0.75"	3.52"	2-1/8"	100
/860345	3/4"-10	7000	1"	6.52"	2.31"	1.4"	1"	5.14"	2-15/16"	100
/860376	3/4"-10	7000	1-1/2"	6.52"	2.31"	1.4"	1"	5.14"	2-15/16"	100
/860437	7/8"-9	8000	1-1/4"	6.52"	2.31"	1.4"	1"	5.14"	2-13/16"	160
/860468	1"-8	10000	1-1/4"	6.52"	2.31"	1.4"	1"	5.14"	2-11/16"	230
/860499	1"-8	10000	1-1/2"	6.52"	2.31"	1.4"	1"	5.14"	2-11/16"	230
/860529	1"-8	10000	2-1/4"	6.52"	2.31"	1.4"	1"	5.14"	2-11/16"	230
/860550	1-1/4"-7	15000	1-7/8"	8.73"	3.19"	1.75"	1.25"	6.5"	4-1/4"	470
/860611	1-1/2"-6	24000	2-3/4"	12.47"	4.19"	2.25"	1.75"	8.55"	6-1/2"	800

Other sizes available. Please call EBN.

WARNING: DO NOT EXCEED SAFE WORK LOAD

Also Available:



Safety



Eye



Latch Kits



Drop Forged
High-Test Chain Hooks



Drop Forged
Safety Snap Hooks



Drop Forged Eye Nuts

Stock Eye Nuts listed below, other than Blanks, are drilled and tapped standard regardless of finish. Both types drilled only, with special tapping or finish supplied to specification. Loads are based on a safety factor of 5 to 1. Blanks are self-colored. NOTE: Loads shown apply to Eye Nuts only, based on a vertical pull, and not to any connecting bolt or stud.

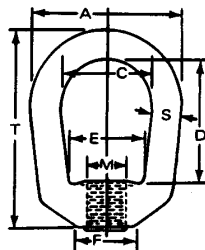

Regular Eye Nuts

SN No.	Ball Size	Tap Size	Drilled & Tapped	
			Self-Colored Part No.	Hot Galvanized Part No.
C-186A	1/4"	1/4"-20	25CEYE	25CEYEG
C-186B	1/4"	5/16"-18	31CEYE	31CEYEG
C-187A	5/16"	3/8"-16	37CEYE	37CEYEG
C-185B	3/8"	7/16"-14	43CEYE	43CEYEG
C-185A	3/8"	1/2"-13	50CEYE	50CEYEG
C-181A	1/2"	5/8"-11	62CEYE	62CEYEG
C-184A	5/8"	3/4"-10	75CEYE	75CEYEG
C-188A	3/4"	7/8"-9	87CEYE	87CEYEG
C-188B	3/4"	1"-8	100CEYE	100CEYEG

Some sizes also available in Stainless Steel.

Specifications

SN No.	Tap Sizes		Dimensions - Inches							Working Load Limit (Tons)	Drilled & Tapped Wgt. Per 100	Blank Wgt. Per 100
	Std. M	Max N	A	C	D	E	F	S	T			
C-186A	1/4"-20	3/8"	1-1/4"	3/4"	1-1/16"	19/32"	1/2"	1/4"	1-11/16"	.26	8.2	9
C-186B	5/16"-18	3/8"	1-1/4"	3/4"	1-1/16"	19/32"	1/2"	1/4"	1-11/16"	.42	8	9
C-187A	3/8"-16	7/16"	1-5/8"	1"	1-1/4"	3/4"	9/16"	5/16"	2-1/16"	.62	15.7	16
C-185B	7/16"-14	1/2"	2"	1-1/4"	1-1/2"	1"	13/16"	3/8"	2-1/2"	.85	29.7	31
C-185A	1/2"-13	1/2"	2"	1-1/4"	1-1/2"	1"	13/16"	3/8"	2-1/2"	1.12	29.3	31
C-181A	5/8"-11	3/4"	2-1/2"	1-1/2"	2"	1-3/16"	1"	1/2"	3-3/16"	1.8	61.5	66
C-184A	3/4"-10	7/8"	3"	1-3/4"	2-3/8"	1-3/8"	1-1/8"	5/8"	3-7/8"	2.6	103	112
C-188A	7/8"-9	1"	3-1/2"	2"	2-5/8"	1-5/8"	1-5/16"	3/4"	4-5/16"	3.6	163	183
C-188B	1"-8	1"	3-1/2"	2"	2-5/8"	1-5/8"	1-5/16"	3/4"	4-5/16"	3.6	161	183

Drop Forged Blank Rod Ends

Drop forged. Listed diameters and lengths carried in stock blank, self-colored. Drilling, threading, other machining and plating furnished to specification. NOTE: Average properties of 1035 natural hot rolled steel 75/85,000 lbs. P.S.I. tensile, 40/55,000 lbs. P.S.I. yield.

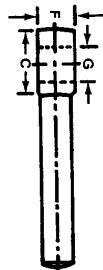
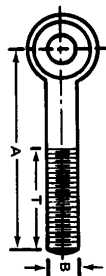

Part No.	Mfg. No.	Dimensions - Inches				Weight Per 100
		Shank Diameter (B)	Boss Diameter (C)	Boss Thickness (F)	Length (A) In Inches	
25N300FRE	18005 4	1/4"	1/2"	9/32"	3"	6.1
25N600FRE	18010 8	1/4"	1/2"	9/32"	6"	11
31N300FRE	18015 3	5/16"	5/8"	11/32"	3"	9.5
31N600FRE	18020 7	5/16"	5/8"	11/32"	6"	18
37N212FRE	18025 2	3/8"	11/16"	3/8"	2-1/8"	12
37N250FRE	18030 6	3/8"	3/4"	3/8"	2-1/2"	12.5
37N300FRE	18035 1	3/8"	3/4"	7/16"	3"	14
37N600FRE	18040 5	3/8"	3/4"	7/16"	6"	25.5
43N600FRE	18045 0	7/16"	7/8"	1/2"	6"	35
50N175FRE	18050 4	1/2"	15/16"	9/16"	1-3/4"	22
50N312FRE	18055 9	1/2"	15/16"	9/16"	3-1/8"	27.5
50N350FRE	18060 3	1/2"	1"	9/16"	3-1/2"	30
50N600FRE	18065 8	1/2"	1"	9/16"	6"	47
50N1000FRE	18070 2	1/2"	1"	9/16"	10"	70
62N300FRE	18075 7	5/8"	1-1/4"	11/16"	3"	45.5
62N350FRE	18080 1	5/8"	1-3/16"	5/8"	3-1/2"	48
62N600FRE	18085 6	5/8"	1-1/4"	11/16"	6"	77.5
62N800FRE	18090 0	5/8"	1-1/4"	11/16"	8"	92
62N1000FRE	18095 5	5/8"	1-1/4"	11/16"	10"	119
75N350FRE	18100 6	3/4"	1-1/2"	13/16"	3-1/2"	82
75N600FRE	18105 1	3/4"	1-1/2"	13/16"	6"	112
75N1000FRE	18110 5	3/4"	1-1/2"	13/16"	10"	163.5
87N600FRE	18115 0	7/8"	1-3/4"	15/16"	6"	164
87N1200FRE	18120 4	7/8"	1-3/4"	15/16"	12"	377
100N600FRE	18125 9	1"	2"	1-1/16"	6"	216
100N1200FRE	18130 3	1"	2"	1-1/16"	12"	354
125N1200FRE	18135 8	1-1/4"	2-1/2"	1-5/16"	12"	595

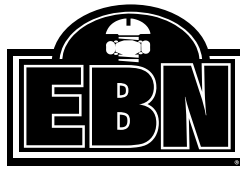

Round Bend U-Bolts (BUUZ)

Round Bend U-Bolts for Steel or Wrought Iron pipe sizes 1/4"-18" inclusive, as listed on this page, are produced from low carbon steel and supplied with NC rolled threads and two (2) hex nuts. In addition, U-Bolt plate is available if required.

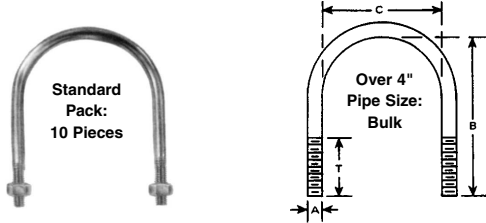

Some sizes also available in Stainless Steel

Zinc Plated

U-Bolt Dimensions - Inches				For		Pipe Size
SN No.	Diameter & Thread (A)	I.D. (C)	Inside Length (B)	Thread Length (T)		
01	1/4"-20	9/16"	1-1/4"	3/4"	1/4"	
02	1/4"-20	3/4"	1-1/4"	5/8"	3/8"	
03	1/4"-20	3/4"	2-1/4"	1-1/2"	3/8"	
04	1/4"-20	1"	1-3/4"	1"	1/2"	
04L	1/4"-20	1"	2-3/4"	1-1/4"	1/2"	
05	1/4"-20	1-1/8"	2"	1"	3/4"	
05L	1/4"-20	1-1/8"	3-1/8"	1-1/2"	3/4"	
06	1/4"-20	1-1/4"	2-1/4"	1-1/4"	3/4"	
07	1/4"-20	1-1/2"	2-3/4"	1-3/8"	1"	
08	1/4"-20	1-3/4"	3"	1-3/8"	1-1/4"	
09	1/4"-20	2"	3-1/4"	1-3/8"	1-1/2"	
010	5/16"-18	1"	2-3/16"	1-3/8"	1/2"	
0101	5/16"-18	1-1/8"	2-3/16"	1"	3/4"	
011	5/16"-18	1-3/8"	2-3/16"	1"	1"	
011L	5/16"-18	1-3/8"	3-5/8"	2"	1"	
012	5/16"-18	1-1/2"	2-3/16"	1"	1"	
013	5/16"-18	1-3/4"	2-11/16"	1-1/8"	1-1/4"	
013L	5/16"-18	1-3/4"	4-1/2"	2"	1-1/4"	
014	5/16"-18	2"	2-11/16"	1"	1-1/2"	
014L	5/16"-18	2"	4-3/4"	3"	1-1/2"	
015	5/16"-18	2-1/2"	3-3/16"	1"	2"	
015L	5/16"-18	2-1/2"	5-5/8"	3"	2"	
016	5/16"-18	3"	3-11/16"	1"	2-1/2"	
017	3/8"-16	1"	2-1/4"	1-1/4"	1/2"	
018	3/8"-16	1-1/4"	2-1/4"	1-1/4"	3/4"	
019	3/8"-16	1-1/2"	2-1/2"	1-1/2"	1"	
020	3/8"-16	1-3/4"	2-3/4"	1-1/8"	1-1/4"	
021	3/8"-16	2"	2-5/8"	1-1/4"	1-1/2"	
022	3/8"-16	2-1/2"	3-1/8"	1-1/4"	2"	
023	3/8"-16	3"	3-5/8"	1-1/4"	2-1/2"	
023L	3/8"-16	3"	6-5/8"	3"	2-1/2"	
024	3/8"-16	3-1/2"	4-1/8"	1-1/4"	3"	
025	1/2"-13	3"	4-1/2"	1-5/8"	2-1/2"	
026	1/2"-13	3-1/2"	5"	1-1/2"	3"	
026L	1/2"-13	3-1/2"	8-1/2"	3"	3"	
027	1/2"-13	4"	5-1/2"	1-1/2"	3-1/2"	
028	1/2"-13	4-1/2"	6"	1-1/2"	4"	
029	1/2"-13	5-5/8"	7-1/4"	2"	5"	
030	1/2"-13	6-3/4"	8-3/8"	2"	6"	
031	1/2"-13	8-3/4"	10-3/8"	2"	8"	
032	*3/4"-10	10-7/8"	13-13/16"	4"	10"	
033	*7/8"-9	12-7/8"	16-1/16"	4-1/4"	12"	
034	*7/8"-9	14-1/8"	17-5/16"	4-1/4"	14"	
035	*7/8"-9	16-1/8"	19-5/16"	4-1/4"	16"	
036	*1"-8	18-1/8"	21-11/16"	4-3/4"	18"	

* Full Stock Diameter with Cut Thread

Other sizes & types available

NOTE: Zinc plated and hot galvanized finishes are standard. Other types of rust preventative coatings or self-colored (black) available on a special basis. Round, Square or "V" type U-Bolts to 1" diameter manufactured to specifications in both ferrous and non-ferrous metals.



Dimensions of Welded and Seamless Steel Pipe

Pipe Size	Outside Diameter
1/4"	.540"
3/8"	.675"
1/2"	.840"
3/4"	1.05"
1"	1.315"
1-1/4"	1.66"
1-1/2"	1.90"
2"	2.375"
2-1/2"	2.875"
3"	3.500"
3-1/2"	4.000"
4"	4.500"
5"	5.563"
6"	6.625"
8"	8.625"
10"	10.750"
12"	12.750"
14"	14.000"
16"	16.000"
18"	18.000"

Also Available: Round Bend Long Tangent U-Bolts, Square Bend U-Bolts





Zinc Plated Turned Eye Bolts (EBBZ)

Turned eye bolts are manufactured from low carbon cold drawn steel wire and are supplied with NC rolled machine threads with one hex nut unassembled. Zinc plated finish is standard; other rust preventative finishes or self-colored available on a special basis. When it is not feasible to utilize a standard eye bolt, we can manufacture to your specifications.

Machine
Thread

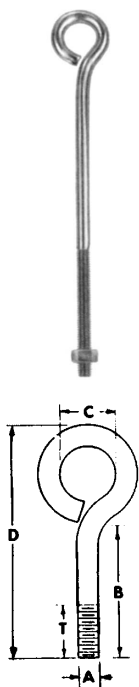

**Many sizes also
available in
Stainless Steel
or with Lag Thread**



SN No.	Dimensions – Inches					Weight Per 100 In lbs.	Working Load Limit lbs.
	Thread Diameter (A)	Shank Length (B)	I.D. Eye (C)	Overall Length (D)	Thread Length (T)		
A-1	1/8" (6-32)	3/4"	1/4"	1-1/4"	5/8"	.75	22
B-1	5/32" (8-32)	1-1/8"	1/4"	1-11/16"	1"	1.31	36
C-1	3/16" (10-24)	1"	3/8"	1-11/16"	7/8"	1.81	38
C-2	3/16" (10-24)	1-3/8"	5/16"	2"	1-1/4"	1.875	38
C-3	3/16" (10-24)	2"	3/8"	2-11/16"	1"	2.375	38
C-4	3/16" (10-24)	3"	3/8"	3-11/16"	1-1/2"	2.94	38
D-1	7/32" (12-24)	1-1/2"	3/8"	2-1/4"	1-3/8"	1.67	52
E-1	1/4"-20	1"	1/2"	2"	7/8"	3.75	74
E-2	1/4"-20	1-1/2"	1/2"	2-1/2"	1-1/4"	4.375	74
E-2A	1/4"-20	1-7/8"	7/16"	2-3/4"	1-5/8"	5.2	74
E-3	1/4"-20	2"	1/2"	3"	1-1/4"	5	74
E-4	1/4"-20	2-1/2"	1/2"	3-1/2"	1-1/4"	5.6	74
E-5	1/4"-20	3"	1/2"	4"	1-1/2"	6.3	74
E-6	1/4"-20	3-1/2"	1/2"	4-1/2"	2"	6.9	74
E-7	1/4"-20	4"	1/2"	5"	2-1/2"	7.5	74
E-8	1/4"-20	5"	1/2"	6"	3"	8	74
E-9	1/4"-20	6"	1/2"	7"	4"	9	74
F-1	5/16"-18	1"	5/8"	2-1/8"	7/8"	7	96
F-2	5/16"-18	2"	5/8"	3-1/8"	1-1/4"	9	96
F-2A	5/16"-18	2-1/4"	9/16"	3-3/8"	2"	9.7	96
F-3	5/16"-18	2-1/2"	5/8"	3-5/8"	1-1/4"	10	96
F-4	5/16"-18	3"	5/8"	4-1/8"	1-1/2"	11	96
F-5	5/16"-18	3-1/2"	5/8"	4-5/8"	2"	11	96
F-6	5/16"-18	4"	5/8"	5-1/8"	2-1/2"	12	96
F-7	5/16"-18	5"	5/8"	6-1/8"	3"	14	96
F-8	5/16"-18	6"	5/8"	7-1/8"	4"	15	96
F-9	5/16"-18	6-1/2"	7/8"	7-3/4"	4"	18	96
G-1	3/8"-16	1"	3/4"	2-1/2"	7/8"	12	144
G-2	3/8"-16	2"	3/4"	3-1/2"	1-1/4"	15	144
G-2A	3/8"-16	2-1/2"	21/32"	3-3/4"	2-1/4"	15.7	144
G-3	3/8"-16	2-1/2"	3/4"	4"	1-1/2"	15.5	144
G-4	3/8"-16	3"	3/4"	4-1/2"	1-1/2"	17	144
G-5	3/8"-16	3-1/2"	3/4"	5"	2"	18	144
G-6	3/8"-16	4"	3/4"	5-1/2"	2-1/2"	21	144
G-7	3/8"-16	5"	3/4"	6-1/2"	3"	22	144
G-8	3/8"-16	6"	3/4"	7-1/2"	4"	24	144
G-9	3/8"-16	8"	3/4"	9-1/2"	4"	30	144
G-10	3/8"-16	10"	3/4"	11-1/2"	4"	34	144
G-11	3/8"-16	12"	3/4"	13-1/2"	4"	39	144
H-1	7/16"-14	6"	7/8"	7-3/4"	4"	36	216
H-2	7/16"-14	8"	7/8"	9-3/4"	4"	42	216
J-1	1/2"-13	2"	1"	4"	1-1/2"	33	298
J-2	1/2"-13	4"	1"	6"	2-1/2"	41	298
J-3	1/2"-13	6"	1"	8"	4"	50	298
J-4	1/2"-13	8"	1"	10"	4"	58	298
J-5	1/2"-13	10"	1"	12"	4"	68	298

Standard Pack: A-1 through D-1: 50 Pieces
E-1 through J-5: 10 Pieces



Zinc Plated Steel "Square Key"

Diameter Tolerances: plus .003 minus .000 Special lengths available upon request.

Square Key

Size	12" Length			36" Length			Estimated Weight Per 100 Ft. lbs.
	Part No.	Bundle		Part No.	Bundle		
		Quantity	Weight lbs.		Quantity	Weight lbs.	
1/8"	12R1200RKSZ	6	.32	12R3600RKSZ	N.A.	N.A.	5.3
5/32"	15R1200RKSZ	6	.50	15R3600RKSZ	N.A.	N.A.	8.3
3/16"	18R1200RKSZ	6	.72	18R3600RKSZ	N.A.	N.A.	12
1/4"	25R1200RKSZ	6	1.32	25R3600RKSZ	6	3.96	22
5/16"	31R1200RKSZ	6	1.98	31R3600RKSZ	6	5.94	33
3/8"	37R1200RKSZ	6	2.88	37R3600RKSZ	6	8.64	48
7/16"	43R1200RKSZ	3	1.95	43R3600RKSZ	3	5.85	65
1/2"	50R1200RKSZ	3	2.55	50R3600RKSZ	3	7.65	85
9/16"	56R1200RKSZ	3	3.24	56R3600RKSZ	3	9.72	108
5/8"	62R1200RKSZ	3	3.99	62R3600RKSZ	3	11.97	133
11/16"	68R1200RKSZ	3	4.80	68R3600RKSZ	3	14.40	160
3/4"	75R1200RKSZ	3	5.70	75R3600RKSZ	3	17.10	190
13/16"	81R1200RKSZ	3	6.75	81R3600RKSZ	3	20.25	225
7/8"	87R1200RKSZ	3	7.80	87R3600RKSZ	3	23.40	260
1"	100R1200RKSZ	3	10.2	100R3600RKSZ	3	30.60	340

NOTE: Standard carton quantities shown for information purposes.

Zinc Plated Steel "Rounds"

*Also available in self-colored finish for welding. Diameters 3/16" to 3/4" inclusive are cold drawn steel. Produced to cold finish tolerances. 7/8" and 1" rounds are Hot Rolled. 72", 120" and 144" lengths are also available.

Rounds

Diameter or Size	Color Code	Part No.	Length Inches	Stock				Estimated Weight Per 100 Ft. lbs.
				Bundle		Carton		
				Quantity	Weight lbs.	Quantity	Weight lbs.	
3/16"	Green	18R3600RCRZ	36"	5	1.4	200	56	9.4
1/4"	Blue	25R3600RCRZ	36"	5	2.5	170	85	16.7
5/16"	Red	31R3600RCRZ	36"	5	3.9	110	86	26.1
3/8"	Yellow	37R3600RCRZ	36"	5	5.6	75	84	37.6
7/16"	Green	43R3600RCRZ	36"	5	7.7	55	85	51.1
1/2"	Blue	50R3600RCRZ	36"	5	11	40	80	66.8
5/8"	Red	62R3600RCRZ	36"	3	9.4	27	85	104.3
3/4"	Yellow	75R3600RCRZ	36"	3	13.5	18	81	150.2
7/8"	Green	87R3600RCRZ	36"	3	18.2	15	91	204
1"	Red	100R3600RCRZ	36"	3	24	12	96	267

Some sizes are available in stainless steel (S) and brass (B).

Also Available: Stainless Steel Section



Shoulder
Machinery Eye Bolts



Plain



Turned Eye Bolts



S-Hook



Round Bend U-Bolts

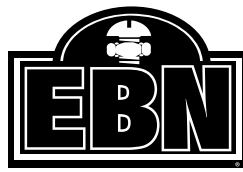

Formed Or Forged Fittings

The schematic drawings in adjoining columns represent basic rod or wire forms and steel eye bolt forgings. Space does not permit the design illustrations of all parts that we are capable of manufacturing. A review of complete catalog literature will indicate an extensive listing of standard stock sizes of round bend U-Bolts, turned or formed eye bolts and forged steel eye bolts in several patterns. When it is not feasible to utilize a standard product, we are prepared and equipped to manufacture requirements to specification. Inquiries are solicited. Variation in quantity: on special items we reserve the right to a maximum 10% variation for allowances in manufacture.

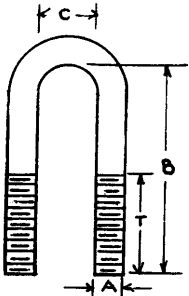

Figure No. 1

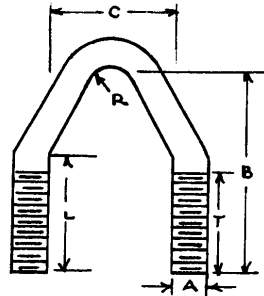

Figure No. 2

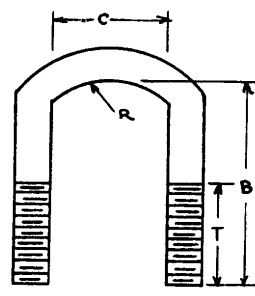

Figure No. 3

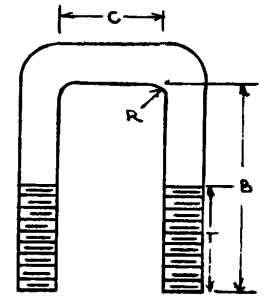

Figure No. 4

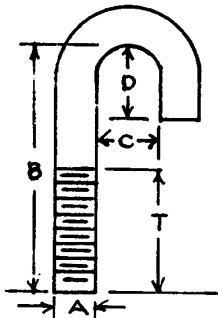

Figure No. 5

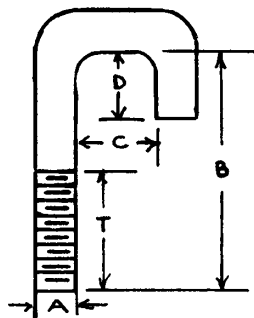

Figure No. 6

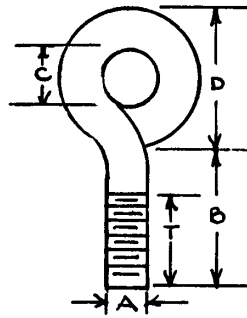

Figure No. 7

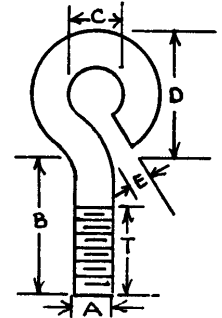

Figure No. 8

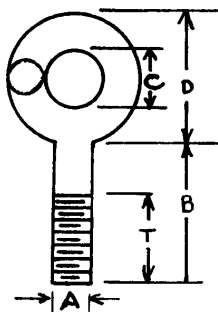

Figure No. 9

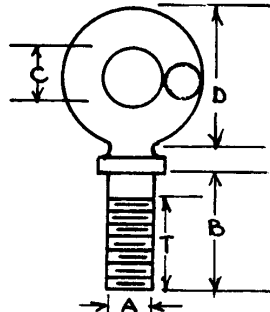

Figure No. 10

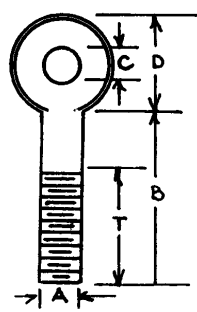
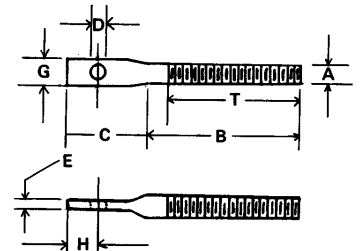

Figure No. 11



Spade Bolt

Evansville, IN
Jasper, IN
Vincennes, IN

812-477-0077
812-482-5105
812-882-4090



Henderson, KY
Owensboro, KY
Mt. Vernon, IL

270-830-0077
270-684-0877
618-244-7156

Keystock

Standard Grades

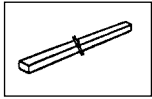

Special Grades

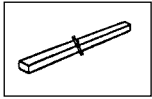

Non-Ferrous

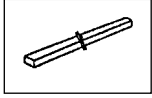

Step Keys

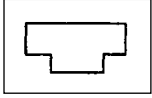

Shaftkeys

Gib Keys

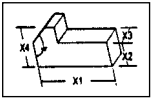

Machine Keys

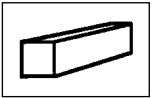

Hi-Pro Keys



Woodruff Keys



Bars And Shafts

Rounds

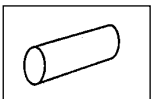

Hex

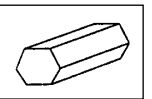

Keyed Shafts

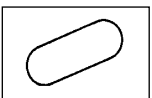

Ground Stock

Drill Rod

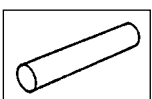

Ground Flats

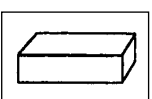

Shims

Shim Stock

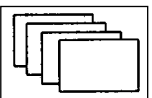

Slotted Shims

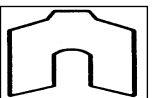

Keyed Spacers

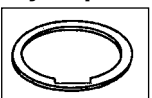

Shims

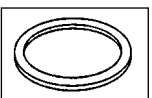

**Call For
Available Sizes**

Keystock 12" Long

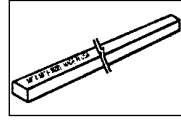

Size	Zinc Part #	Plain Part #
1/16	6R1200RKSZ	6R1200RKS
3/32	9R1200RKSZ	9R1200RKS
1/8	12R1200RKSZ	12R1200RKS
5/32	15R1200RKSZ	15R1200RKS
3/16	18R1200RKSZ	18R1200RKS
1/4	25R1200RKSZ	25R1200RKS
5/16	31R1200RKSZ	31R1200RKS
3/8	37R1200RKSZ	37R1200RKS
7/16	43R1200RKSZ	43R1200RKS
1/2	50R1200RKSZ	50R1200RKS
9/16	56R1200RKSZ	56R1200RKS
5/8	62R1200RKSZ	62R1200RKS
3/4	75R1200RKSZ	75R1200RKS
7/8	87R1200RKSZ	87R1200RKS
1	100R1200RKSZ	100R1200RKS
1-1/8	112R1200RKSZ	112R1200RKS
1-3/16	118R1200RKSZ	118R1200RKS
1-1/4	125R1200RKSZ	125R1200RKS
1-3/8	137R1200RKSZ	137R1200RKS
1-1/2	150R1200RKSZ	150R1200RKS
1-5/8	162R1200RKSZ	162R1200RKS
1-3/4	175R1200RKSZ	175R1200RKS
1-7/8	187R1200RKSZ	187R1200RKS
2	200R1200RKSZ	200R1200RKS
2-1/4	225R1200RKSZ	225R1200RKS

Also available in 36"

Woodruff Keys (KWO)

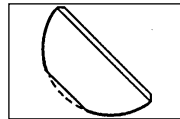

SN No.	Size	
Woodruff201	1/16"	1/4"
Woodruff206	1/16"	5/16"
Woodruff207	3/32"	
Woodruff211	1/16"	3/8"
Woodruff212	3/32"	
Woodruff213	1/8"	
Woodruff1	1/16"	1/2"
Woodruff2	3/32"	
Woodruff3	1/8"	
Woodruff4	3/32"	
Woodruff5	1/8"	5/8"
Woodruff6	5/32"	
Woodruff61	3/16"	3/4"
Woodruff7	1/8"	
Woodruff8	5/32"	
Woodruff9	3/16"	
Woodruff91	1/4"	
Woodruff10	5/32"	
Woodruff11	3/16"	7/8"
Woodruff12	7/32"	
WoodruffA	1/4"	1"
Woodruff13	3/16"	
Woodruff14	7/32"	
Woodruff141	1/4"	
Woodruff15	1/4"	
WoodruffB	5/16"	
Woodruff152	3/8"	

Woodruff Keys (Cont.)

SN No.	Size	
Woodruff16	3/16"	1-1/8"
Woodruff17	7/32"	
Woodruff18	1/4"	
WoodruffC	5/16"	1-1/4"
Woodruff19	3/16"	
Woodruff20	7/32"	
Woodruff21	1/4"	
WoodruffD	5/16"	1-3/8"
WoodruffE	3/8"	
Woodruff22	1/4"	
Woodruff23	5/16"	1-1/2"
WoodruffF	3/8"	
Woodruff24	1/4"	
Woodruff25	5/16"	
WoodruffG	3/8"	2-1/8"
Woodruff126	3/16"	
Woodruff127	1/4"	
Woodruff128	5/16"	2-3/4"
Woodruff129	3/8"	
Woodruff26	3/16"	
Woodruff27	1/4"	
Woodruff28	5/16"	
Woodruff29	3/8"	
WoodruffRX	1/4"	
WoodruffSX	5/16"	
WoodruffTX	3/8"	
WoodruffUX	7/16"	
WoodruffVX	1/2"	3-1/2"
WoodruffR	1/4"	
WoodruffS	5/16"	
WoodruffT	3/8"	
WoodruffU	7/16"	
WoodruffV	1/2"	
Woodruff30	3/8"	
Woodruff31	7/16"	
Woodruff32	1/2"	
Woodruff33	9/16"	
Woodruff34	5/8"	
Woodruff35	11/16"	
Woodruff36	3/4"	

Drill Rod (RDO)



3' - Length

Drill Rod Information For Amateurs

- **W-1:** Most popular, versatile, and least expensive. Often used without heat treatment for maintenance applications. Because of rapid cooling when water quenched, allow for warpage and shrinkage if heat treated. **(Color Code: Blue)**
- **D-1:** Fully spheroidized structure allows a minimum of deformation after heat treatment. Excellent abrasion resistance, toughness, and machinability characteristics. Good for post-heat treatment grinding. **(Color Code: Yellow)**
- **A-2:** Fine grain fully spheroidized 5% chrome tool steel. Especially suited for thin parts prone to cracking during heat treatment. **(Color Code: White)**

Oil Hardened, Available In Water & Air

Tolerances		
Diameter	Dia. Tool	Length Tol.
.124" & smaller	+/- .0003"	+1/8"/-0
.125" - 1.50"	+/- .0005"	+1/8"/-0
1.50" - 2.00"	+/- .00075"	+1/8"/-0

Evansville, IN 812-477-0077
 Jasper, IN 812-482-5105
 Vincennes, IN 812-882-4090

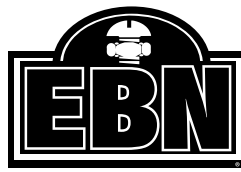

Henderson, KY 270-830-0077
 Owensboro, KY 270-684-0877
 Mt. Vernon, IL 618-244-7156

Drill Rod (RDO) (Cont.)

Code: RDO - Oil Hard
 RCR - Cold Rolled

Sizes	Sizes	Sizes	Sizes
1/16"	13/32"	47/64"	1-1/8"
5/64"	27/64"	3/4"	1-5/32"
3/32"	7/16"	49/64"	1-3/16"
7/64"	29/64"	25/32"	1-7/32"
1/8"	15/32"	51/64"	1-1/4"
9/64"	31/64"	13/16"	1-9/32"
5/32"	1/2"	53/64"	1-5/16"
11/64"	33/64"	27/32"	1-11/32"
3/16"	17/32"	55/64"	1-3/8"
13/64"	35/64"	7/8"	1-13/32"
7/32"	9/16"	57/64"	1-7/16"
15/64"	37/64"	29/32"	1-15/32"
1/4"	19/32"	59/64"	1-1/2"
17/64"	39/64"	15/16"	1-9/16"
9/32"	5/8"	61/64"	1-5/8"
19/64"	41/64"	31/32"	1-11/16"
5/16"	21/32"	63/64"	1-3/4"
21/64"	43/64"	1"	1-13/16"
11/32"	11/16"	1-1/32"	1-7/8"
23/64"	45/64"	1-1/16"	1-15/16"
3/8"	23/32"	1-3/32"	2"
25/64"			

Shaft Collars

Solid Collars (SHF/SS)



SN No.	I.D. (Bore)	Outside Diameter	Thickness (Width)
0125	1/8"	3/8"	1/4"
0187	3/16"	7/16"	1/4"
0250	1/4"	1/2"	5/16"
0312	5/16"	5/8"	5/16"
0375	3/8"	3/4"	3/8"
0437	7/16"	7/8"	7/16"
0500	1/2"	1"	7/16"
0562	9/16"	1"	7/16"
0625	5/8"	1-1/8"	1/2"
0687	11/16"	1-1/4"	9/16"
0750	3/4"	1-1/4"	9/16"
0812	13/16"	1-5/16"	9/16"
0875	7/8"	1-1/2"	9/16"
0937	15/16"	1-5/8"	9/16"
1000	1"	1-5/8"	5/8"
1062	1-1/16"	1-3/4"	5/8"
1125	1-1/8"	1-3/4"	5/8"
1187	1-3/16"	2"	11/16"
1250	1-1/4"	2"	11/16"
1312	1-5/16"	2-1/8"	11/16"
1375	1-3/8"	2-1/8"	3/4"
1437	1-7/16"	2-1/4"	3/4"
1500	1-1/2"	2-1/4"	3/4"
1562	1-9/16"	2-1/2"	13/16"
1625	1-5/8"	2-1/2"	13/16"
1687	1-11/16"	2-1/2"	13/16"
1750	1-3/4"	2-3/4"	7/8"
1812	1-13/16"	2-3/4"	7/8"
1875	1-7/8"	2-3/4"	7/8"
1937	1-15/16"	3"	7/8"
2000	2"	3"	7/8"
2125	2-1/8"	3"	7/8"
2187	2-3/16"	3-1/4"	15/16"
2250	2-1/4"	3-1/4"	15/16"

Solid Collars (Cont.)

Part No.	I.D. (Bore)	Outside Diameter	Thickness (Width)
2312	2-5/16"	3-1/4"	15/16"
2375	2-3/8"	3-1/4"	15/16"
2437	2-7/16"	3-1/2"	1"
2500	2-1/2"	3-1/2"	1"
2562	2-9/16"	3-3/4"	1-1/8"
2625	2-5/8"	4"	1-1/8"
2687	2-11/16"	4"	1-1/8"
2750	2-3/4"	4"	1-1/8"
2875	2-7/8"	4-1/4"	1-1/8"
2937	2-15/16"	4-1/4"	1-1/8"
3000	3"	4-1/4"	1-1/8"
3187	3-3/16"	4-1/4"	1-1/8"
3437	3-7/16"	4-1/2"	1-1/8"
3937	3-15/16"	5"	1-1/8"
4437	4-7/16"	6"	1-3/8"
4937	4-15/16"	6-3/8"	1-3/8"

Split Collars

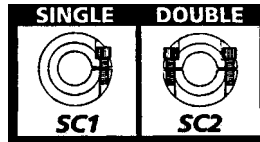

(SHF/1P)(SHF/2P)

SN No.	I.D. (Bore)	Outside Diameter	Thickness (Width)
0125	1/8"	5/8"	5/16"
0187	3/16"	5/8"	5/16"
0250	1/4"	5/8"	5/16"
0312	5/16"	11/16"	5/16"
0375	3/8"	7/8"	3/8"
0437	7/16"	15/16"	3/8"
0500	1/2"	1-1/8"	13/32"
0562	9/16"	1-5/16"	7/16"
0625	5/8"	1-5/16"	7/16"
0687	11/16"	1-1/2"	1/2"
0750	3/4"	1-1/2"	1/2"
0812	13/16"	1-5/8"	1/2"
0875	7/8"	1-5/8"	1/2"
0937	15/16"	1-3/4"	1/2"
1000	1"	1-3/4"	1/2"
1062	1-1/16"	1-7/8"	1/2"
1125	1-1/8"	1-7/8"	1/2"
1187	1-3/16"	2-1/16"	1/2"
1250	1-1/4"	2-1/16"	1/2"
1312	1-5/16"	2-1/4"	9/16"
1375	1-3/8"	2-1/4"	9/16"
1437	1-7/16"	2-1/4"	9/16"
1500	1-1/2"	2-3/8"	9/16"
1562	1-9/16"	2-3/8"	9/16"
1625	1-5/8"	2-5/8"	11/16"
1687	1-11/16"	2-3/4"	11/16"
1750	1-3/4"	2-3/4"	11/16"
1875	1-7/8"	3"	11/16"
1937	1-15/16"	3"	11/16"
2000	2"	3"	11/16"
2125	2-1/8"	3-1/4"	3/4"
2187	2-3/16"	3-1/4"	3/4"
2250	2-1/4"	3-1/4"	3/4"
2375	2-3/8"	3-1/2"	3/4"
2437	2-7/16"	3-1/2"	3/4"
2500	2-1/2"	3-3/4"	7/8"
2625	2-5/8"	3-7/8"	7/8"
2687	2-11/16"	4"	7/8"
2750	2-3/4"	4"	7/8"
2875	2-7/8"	4-1/4"	7/8"

Spring Pins



Part No.	Length	Pkg. Qty.
1/16"		
6R18PRP	3/16"	100
6R25PRP	1/4"	100
6R31PRP	5/16"	100
6R37PRP	3/8"	100
6R43PRP	7/16"	100
6R50PRP	1/2"	100
6R56PRP	9/16"	100
6R62PRP	5/8"	100
6R68PRP	11/16"	100
6R75PRP	3/4"	100
6R81PRP	13/16"	100
6R87PRP	7/8"	100
6R93PRP	15/16"	100
6R100PRP	1"	100
5/64"		
7R18PRP	3/16"	100
7R25PRP	1/4"	100
7R31PRP	5/16"	100
7R37PRP	3/8"	100
7R43PRP	7/16"	100
7R50PRP	1/2"	100
7R56PRP	9/16"	100
7R62PRP	5/8"	100
7R68PRP	11/16"	100
7R75PRP	3/4"	100
7R81PRP	13/16"	100
7R87PRP	7/8"	100
7R93PRP	15/16"	100
7R100PRP	1"	100
7R112PRP	1-1/8"	100
7R125PRP	1-1/4"	100
7R137PRP	1-3/8"	100
7R150PRP	1-1/2"	100
3/32"		
9R18PRP	3/16"	100
9R25PRP	1/4"	100
9R31PRP	5/16"	100
9R37PRP	3/8"	100
9R43PRP	7/16"	100
9R50PRP	1/2"	100
9R56PRP	9/16"	100
9R62PRP	5/8"	100
9R68PRP	11/16"	100
9R75PRP	3/4"	100
9R81PRP	13/16"	100
9R87PRP	7/8"	100
9R93PRP	15/16"	100
9R100PRP	1"	100
9R112PRP	1-1/8"	100
9R125PRP	1-1/4"	100
9R137PRP	1-3/8"	100
9R150PRP	1-1/2"	100
9R175PRP	1-3/4"	100

Evansville, IN
Jasper, IN
Vincennes, IN

812-477-0077
812-482-5105
812-882-4090



Henderson, KY
Owensboro, KY
Mt. Vernon, IL

270-830-0077
270-684-0877
618-244-7156

Spring Pins (Cont.)

Part No.	Length	Pkg. Qty.
1/8"		
12R25PRP	1/4	100
12R31PRP	5/16	100
12R37PRP	3/8	100
12R43PRP	7/16	100
12R50PRP	1/2	100
12R56PRP	9/16	100
12R62PRP	5/8	100
12R68PRP	11/16	100
12R75PRP	3/4	100
12R81PRP	13/16	100
12R87PRP	7/8	100
12R93PRP	15/16	100
12R100PRP	1	100
12R112PRP	1-1/8	100
12R125PRP	1-1/4	100
12R137PRP	1-3/8	100
12R150PRP	1-1/2	100
12R162PRP	1-5/8	100
12R175PRP	1-3/4	100
12R187PRP	1-7/8	100
12R200PRP	2	100
5/32"		
15R43PRP	7/16	100
15R50PRP	1/2	100
15R56PRP	9/16	100
15R62PRP	5/8	100
15R68PRP	11/16	100
15R75PRP	3/4	100
15R81PRP	13/16	100
15R87PRP	7/8	100
15R93PRP	15/16	100
15R100PRP	1	100
15R112PRP	1-1/8	100
15R125PRP	1-1/4	100
15R137PRP	1-3/8	100
15R150PRP	1-1/2	100
15R162PRP	1-5/8	100
15R175PRP	1-3/4	100
15R187PRP	1-7/8	100
15R200PRP	2	100
15R225PRP	2-1/4	100
15R250PRP	2-1/2	100
3/16"		
18R37PRP	3/8	100
18R43PRP	3/16	100
18R50PRP	1/2	100
18R56PRP	9/16	100
18R62PRP	5/8	100
18R68PRP	11/16	100
18R75PRP	3/4	100
18R81PRP	13/16	100
18R87PRP	7/8	100
18R93PRP	15/16	100
18R100PRP	1	100
18R112PRP	1-1/8	100
18R125PRP	1-1/4	100
18R137PRP	1-3/8	100
18R150PRP	1-1/2	100
18R162PRP	1-5/8	100
18R175PRP	1-3/4	100
18R187PRP	1-7/8	100
18R200PRP	2	100
18R225PRP	2-1/4	100
18R250PRP	2-1/2	100

Part No.	Length	Pkg. Qty.
7/32"		
21R56PRP	9/16	100
21R50PRP	1/2	100
21R62PRP	5/8	100
21R68PRP	11/16	100
21R75PRP	3/4	100
21R81PRP	13/16	100
21R87PRP	7/8	100
21R93PRP	15/16	100
21R100PRP	1	100
21R112PRP	1-1/8	100
21R125PRP	1-1/4	100
21R137PRP	1-3/8	100
21R150PRP	1-1/2	100
21R162PRP	1-5/8	100
21R175PRP	1-3/4	100
21R187PRP	1-7/8	100
21R200PRP	2	100
21R225PRP	2-1/4	100
21R250PRP	2-1/2	100
21R275PRP	2-3/4	100
21R300PRP	3	100
1/4"		
25R50PRP	1/2	100
25R62PRP	5/8	100
25R68PRP	11/16	100
25R75PRP	3/4	100
25R81PRP	13/16	100
25R87PRP	7/8	100
25R93PRP	15/16	100
25R100PRP	1	100
25R112PRP	1-1/8	100
25R125PRP	1-1/4	100
25R137PRP	1-3/8	100
25R150PRP	1-1/2	100
25R162PRP	1-5/8	100
25R175PRP	1-3/4	100
25R187PRP	1-7/8	100
25R200PRP	2	100
25R225PRP	2-1/4	100
25R250PRP	2-1/2	100
25R275PRP	2-3/4	100
25R300PRP	3	100
25R325PRP	3-1/4	100
25R350PRP	3-1/2	100
5/16"		
31R75PRP	3/4	100
31R81PRP	13/16	100
31R87PRP	7/8	100
31R93PRP	15/16	100
31R100PRP	1	100
31R112PRP	1-1/8	100
31R125PRP	1-1/4	100
31R137PRP	1-3/8	100
31R150PRP	1-1/2	100
31R162PRP	1-5/8	100
31R175PRP	1-3/4	100
31R187PRP	1-7/8	100
31R200PRP	2	100
31R225PRP	2-1/4	100
31R250PRP	2-1/2	100
31R275PRP	2-3/4	100
31R300PRP	3	100
31R325PRP	3-1/4	100
31R350PRP	3-1/2	100
31R375PRP	3-3/4	100
31R400PRP	4	100

Part No.	Length	Pkg. Qty.
3/8"		
37R75PRP	3/4	50
37R100PRP	1	50
37R125PRP	1-1/4	50
37R150PRP	1-1/2	50
37R175PRP	1-3/4	50
37R200PRP	2	50
37R225PRP	2-1/4	50
37R250PRP	2-1/2	50
37R275PRP	2-3/4	50
37R300PRP	3	50
37R325PRP	3-1/4	50
37R350PRP	3-1/2	50
37R375PRP	3-3/4	50
37R400PRP	4	50
7/16"		
43R100PRP	1	50
43R125PRP	1-1/4	50
43R150PRP	1-1/2	50
43R175PRP	1-3/4	50
43R200PRP	2	50
43R225PRP	2-1/4	50
43R250PRP	2-1/2	50
43R275PRP	2-3/4	50
43R300PRP	3	50
43R325PRP	3-1/4	50
43R350PRP	3-1/2	50
43R375PRP	3-3/4	50
43R400PRP	4	50
1/2"		
50R125PRP	1-1/4	50
50R150PRP	1-1/2	50
50R175PRP	1-3/4	50
50R200PRP	2	50
50R225PRP	2-1/4	50
50R250PRP	2-1/2	50
50R275PRP	2-3/4	50
50R300PRP	3	50
50R325PRP	3-1/4	50
50R350PRP	3-1/2	50
50R375PRP	3-3/4	50
50R400PRP	4	50

"Success is
 dependent upon
 the glands —
 sweat glands."
 —Zig Ziglar

Evansville, IN 812-477-0077
 Jasper, IN 812-482-5105
 Vincennes, IN 812-882-4090



Henderson, KY 270-830-0077
 Owensboro, KY 270-684-0877
 Mt. Vernon, IL 618-244-7156

Retaining Rings

External Retaining Snap Ring #1400 Plain



Part No.	Size		Quantity Per Box
/YUB20	5/16	31	25
/YUB22	11/32	34	25
/YUB24	3/8	37	25
/YUB26	13/32	40	25
/YUB28	7/16	43	25
/YUB30	15/32	46	25
/YUB32	1/2	50	25
/YUB36	9/16	56	25
/YUB38	19/32	59	25
/YUB40	5/8	62	25
/YUB43	43/64	66	25
/YUB44	11/16	68	25
/YUB48	3/4	75	25
/YUB50	25/32	78	25
/YUB52	13/16	81	25
/YUB56	7/8	87	25
/YUB60	15/16	93	25
/YUB64	1	100	25
/YUB68	1-1/16	106	25
/YUB72	1-1/8	112	25
/YUB76	1-3/16	118	25
/YUB80	1-1/4	125	25
/YUB84	1-5/16	131	25
/YUB88	1-3/8	137	25
/YUB92	1-7/16	143	25
/YUB96	1-1/2	150	25
/YUB100	1-9/16	156	25
/YUB104	1-5/8	162	25
/YUB108	1-11/16	168	25
/YUB112	1-3/4	175	25
/YUB116	1-13/16	181	25
/YUB120	1-7/8	187	25
/YUB128	2	200	25
/YUB132	2-1/16	206	25
/YUB136	2-1/8	212	25
/YUB138	2-5/32	215	25
/YUB144	2-1/4	225	25
/YUB148	2-5/16	231	25
/YUB152	2-3/8	237	25
/YUB156	2-7/16	243	25
/YUB160	2-1/2	250	25
/YUB275X	2-3/4	275	25
/YUB300X	3	300	25

Internal Retaining Snap Ring #1300 Plain



Part No.	Size		Quantity Per Box
/YVB16	1/4	25	25
/YVB20	5/16	31	25
/YVB24	3/8	37	25
/YVB28	7/16	43	25
/YVB32	1/2	50	25
/YVB36	9/16	56	25
/YVB40	5/8	62	25
/YVB44	11/16	68	25
/YVB48	3/4	75	25
/YVB52	13/16	81	25
/YVB56	7/8	87	25
/YVB60	15/16	93	25
/YVB64	1	100	25
/YVB68	1-1/16	106	25
/YVB72	1-1/8	112	25
/YVB76	1-3/16	118	25
/YVB80	1-1/4	125	25
/YVB84	1-5/16	131	25
/YVB88	1-3/8	137	25
/YVB92	1-7/16	143	25
/YVB96	1-1/2	150	25
/YVB100	1-9/16	156	25
/YVB104	1-5/8	162	25
/YVB108	1-11/16	168	25
/YVB112	1-3/4	175	25
/YVB116	1-13/16	181	25
/YVB120	1-7/8	187	25
/YVB124	1-15/16	193	25
/YVB128	2	200	25
/YVB132	2-1/16	206	25
/YVB136	2-1/8	212	25
/YVB140	2-3/16	218	25
/YVB144	2-1/4	225	25
/YVB148	2-5/16	231	25
/YVB152	2-3/8	237	25
/YVB244X	2-7/16	244	25
/YVB250X	2-1/2	250	25
/YVB275X	2-3/4	275	25
/YVB300X	3	300	25

External C Retaining Snap Ring #1800 Plain



Part No.	Size		Quantity Per Box
/YWB08	1/8	12	25
/YWB10	5/32	15	25
/YWB12	3/16	18	25
/YWB14	7/32	21	25
/YWB15	15/64	23	25
/YWB16	1/4	25	25
/YWB18	9/32	28	25
/YWB20	5/16	31	25
/YWB24	3/8	37	25

External C Retaining Snap Ring #1800 Plain (Cont.)

Part No.	Size		Quantity Per Box
/YWB26	13/32	40	25
/YWB28	7/16	43	25
/YWB32	1/2	50	25
/YWB36	9/16	56	25
/YWB40	5/8	62	25
/YWB44	11/16	68	25
/YWB48	3/4	75	25
/YWB52	13/16	81	25
/YWB56	7/8	87	25
/YWB60X	15/16	93	25
/YWB64	1	100	25
/YWB72	1-1/8	112	25
/YWB80	1-1/4	125	25
/YWB88	1-3/8	137	25
/YWB96	1-1/2	150	25
/YWB112	1-3/4	175	25
/YWB128	2	200	25

External E Retaining Snap Ring #1500 Plain



Part No.	Size		Quantity Per Box
/YXB04	1/16	6	25
/YXB06	3/32	9	25
/YXB07	7/64	X11	25
/YXB08	1/8	12	25
/YXB09	9/64	14	25
/YXB10	5/32	15	25
/YXB11	11/64	X17	25
/YXB12	3/16	18	25
/YXB14	7/32	X21	25
/YXB16	1/4	25	25
/YXB20	5/16	X31	25
/YXB24	3/8	37	25
/YXB28	7/16	43	25
/YXB32	1/2	50	25
/YXB40	5/8	62	25
/YXB48	3/4	75	25
/YXB56	7/8	87	25
/YXB64	1	X98	25
/YXB76	1-3/16	X118	25
/YXB88	1-3/8	X137	25

Evansville, IN
Jasper, IN
Vincennes, IN

812-477-0077
812-482-5105
812-882-4090

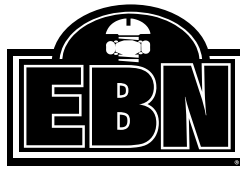

Henderson, KY
Owensboro, KY
Mt. Vernon, IL
270-830-0077
270-684-0877
618-244-7156

O-Rings



Part No.	Size	Thickness S	O.D.	I.D.
/ORING006	006	1/16	1/4	1/8
/ORING007	007	"	9/32	5/32
/ORING009	009	"	11/32	7/32
/ORING010	010	"	3/8	1/4
/ORING011	011	"	7/16	5/16
/ORING012	012	"	1/2	3/8
/ORING013	013	"	9/16	7/16
/ORING014	014	"	5/8	1/2
/ORING015	015	"	11/16	9/16
/ORING016	016	"	3/4	5/8
/ORING017	017	"	13/16	11/16
/ORING018	018	"	7/8	3/4
/ORING019	019	"	15/16	13/16
/ORING020	020	"	1	7/8
/ORING021	021	"	1-1/16	15/16
/ORING022	022	"	1-1/8	1
/ORING025	025	"	1-5/16	1-3/16
/ORING028	028	"	1-3/8	1-3/8
/ORING108	108	3/32	7/16	1/4
/ORING110	110	"	9/16	3/8
/ORING111	111	"	5/8	7/16
/ORING112	112	"	11/16	1/2
/ORING113	113	"	3/4	9/16
/ORING114	114	"	13/16	5/8
/ORING115	115	"	7/8	11/16
/ORING116	116	"	15/16	3/4
/ORING117	117	"	1	13/16
/ORING118	118	"	1-1/16	7/8
/ORING119	119	"	1-1/8	15/16

O-Rings (Cont.)

Part No.	Size	Thickness S	O.D.	I.D.
/ORING120	120	"	1-3/16	1
/ORING121	121	"	1-1/4	1-1/16
/ORING122	122	"	1-5/16	1-1/8
/ORING123	123	"	1-3/8	1-3/16
/ORING124	124	"	1-7/16	1-1/4
/ORING125	125	"	1-1/2	1-5/16
/ORING126	126	"	1-9/16	1-3/8
/ORING127	127	"	1-5/8	1-7/16
/ORING128	128	"	1-11/16	1-1/2
/ORING130	130	"	1-13/16	1-5/8
/ORING137	137	"	2-1/4	2-1/16
/ORING139	139	"	2-3/4	2-3/16
/ORING148	148	"	2-15/16	2-3/4
/ORING202	202	1/8	1/2	1/4
/ORING210	210	"	1	3/4
/ORING211	211	"	1-1/16	13/16
/ORING212	212	"	1-1/8	7/8
/ORING213	213	"	1-3/16	15/16
/ORING214	214	"	1-1/4	1
/ORING215	215	"	1-5/16	1-1/16
/ORING216	216	"	1-3/8	1-1/8
/ORING217	217	"	1-7/16	1-3/16
/ORING218	218	"	1-1/2	1-1/4
/ORING219	219	"	1-9/16	1-5/16
/ORING220	220	"	1-5/8	1-3/8
/ORING221	221	"	1-11/16	1-7/16
/ORING222	222	"	1-3/4	1-1/2
/ORING223	223	"	1-7/8	1-5/8
/ORING224	224	"	2	1-3/4
/ORING225	225	"	2-1/8	1-7/8
/ORING226	226	"	2-1/4	2
/ORING228	228	"	2-1/2	2-1/4
/ORING230	230	"	2-3/4	2-1/2
/ORING232	232	"	3	2-3/4

O-Rings (Cont.)

Part No.	Size	Thickness S	O.D.	I.D.
/ORING234	234	"	3-1/4	3
/ORING235	235	"	3-3/8	3-1/8
/ORING236	236	"	3-1/2	3-1/4
/ORING238	238	1/8	3-3/4	3-1/2
/ORING239	239	"	3-7/8	3-5/8
/ORING240	240	"	4	3-3/4
/ORING242	242	"	4-1/4	4
/ORING244	244	"	4-1/2	4-1/2
/ORING246	246	"	4-3/4	4-1/2
/ORING249	249	"	5-1/8	4-7/8
/ORING250	250	"	5-1/4	5
/ORING254	254	"	5-3/4	5-1/2
/ORING255	255	"	5-7/8	5-5/8
/ORING257	257	"	6-1/8	5-7/8
/ORING260	260	"	6-3/4	6-1/2
/ORING261	261	"	7	6-3/4
/ORING262	262	"	7-1/4	7
/ORING264	264	"	7-3/4	7-1/2
/ORING268	268	"	8-3/4	8-1/2
/ORING326	326	3-1/16	2	1-5/8
/ORING329	329	"	2-3/8	2
/ORING330	330	"	2-1/2	2-1/8
/ORING333	333	"	2-7/8	2-1/2
/ORING336	336	"	3-1/4	2-7/8
/ORING339	339	"	3-5/8	3-1/4
/ORING341	341	"	3-7/8	3-1/2
/ORING342	342	"	4	3-5/8
/ORING344	344	"	4-1/4	3-7/8
/ORING345	345	"	4-3/8	4
/ORING346	346	"	4-1/2	4-1/8
/ORING425	425	"	5	4-1/2
/ORING427	427	"	5-1/4	4-3/4
/ORING428	428	"	5-3/8	4-7/8
/ORING433	433	"	6	5-1/2
/ORING439	439	"	7	6-1/2

Standard Sizes

Grease Fittings (AGF)

SN#	Description	Features	ALEMITE	Lincoln
201610	1/8" NPT	Straight - short	1644-B	-
-	1/8" NPT	Straight - standard	1610-BL	5000
201607	1/8" NPT	Straight - long (1-1/4")	1607-B	5003
201669	1/8" NPT	Straight - extra long (1-3/4")	1669-B	5007
-	1/8" NPT	Straight - super long (2-5/8")	1684-B	5009
-	1/8" NPT	30° Angle	1611-B	5100
211688	1/8" NPT	45° Angle	1688-B	5200
211612	1/8" NPT	65° Angle	1612-B	5300
211613	1/8" NPT	90° Angle	1613-B	5400
-	1/8" NPT Female	Straight	1618-B	5505
201627	1/4" NPT	Straight	1627-B	5050
201629	1/4" NPT	67-1/2° Angle	1629-B	5350
201641	1/4"-28	Straight - standard	1641-B	5010
201652	1/4"-28	Straight - long shank (11/16")	1652-B	5013
201680	1/4"-28	Straight - long (15/16")	1680-B	5014
-	1/4"-28	Straight - incredibly long (1-39/64")	3014-B	-
201637	1/4"-28	45° Angle	1637-B1	5210
-	1/4"-28	45° Angle - long (31/32")	1636-B1	5212
201665	1/4"-28	65° Angle	3010-B	700396
211911	1/4"-28	90° Angle	1911-B1	5410
-	1/4"-28	90° Angle - long (51/64")	1790-B1	5412
201792	1/4"-28 UNF-2A	Straight - short threads	1792-B	5527
-	1/4"-28 UNF-2A	45° Angle - short threads	1770-B1	-
201711	5/16"-24 UNF-2A	Straight	1711-B	5061
201710	3/8"-24 UNF	Straight	1710-B	5062
-	1/8" Drive	Straight - no ball check	3019	-
201728	3/16" Drive	Straight	1728-B	5033
201633	3/16" Drive	Straight - no ball check	1633	5026
-	3/16" Drive	45° Angle	1992-B1	-
201743	1/4" Drive	Straight	1743-B	5029
201952	1/4" Drive	Straight - no ball check	1952	-
-	1/4" Drive	65° Angle	1744-B1	5318
201608	5/16" Drive	Straight	1608-B	5031
-	3/8" Drive	Straight - no ball check	1666	-
331184	1/8" NPT Buttonhead	Straight - ball check	1184-B	5700/5701
331186	1/4" NPT Buttonhead	Straight - ball check	1186-B	5705/5706
331188	3/8" NPT Buttonhead	Straight - ball check	1188-B	5710/5711

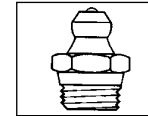

H1644

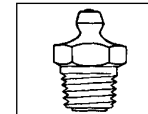

H1610

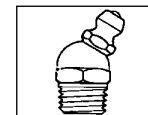

H1611



H1688

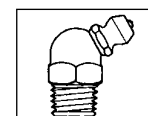

H1612

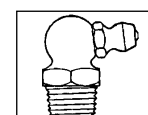

H1613

Evansville, IN
 Jasper, IN
 Vincennes, IN

812-477-0077
 812-482-5105
 812-882-4090



Henderson, KY
 Owensboro, KY
 Mt. Vernon, IL

270-830-0077
 270-684-0877
 618-244-7156

Self Tapping

SN#	Description	Features	ALEMITE	Lincoln
205570	1/8" NPT	Straight	1720-B	205000
-	1/8" NPT	45° Angle	1724-B	205200
-	1/8" NPT	90° Angle	1723-B	205400
205530	1/4"-28	Straight	3038-B	205010
-	1/4"-28	45° Angle	3053-B	205210
-	1/4"-28	90° Angle	3054-B	205410

Accessories

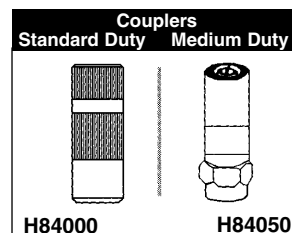
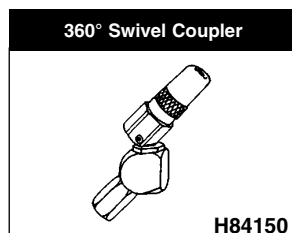
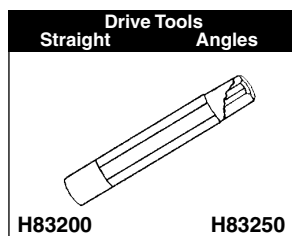
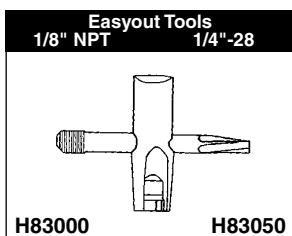
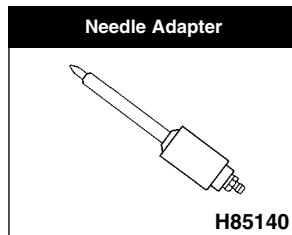

Clevis Pins

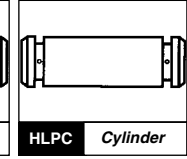
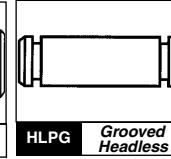
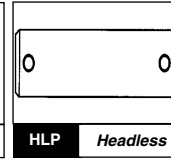
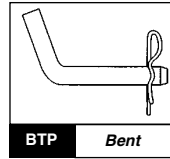
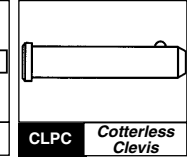
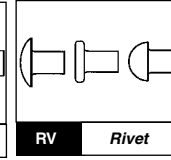
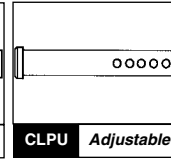
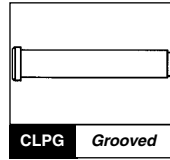
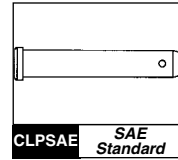
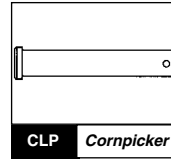

Three-Point Pins

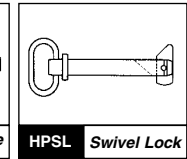
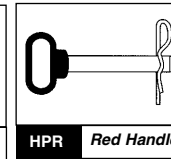
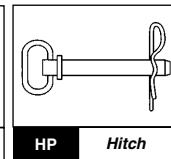
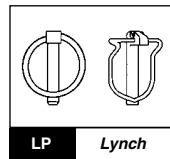
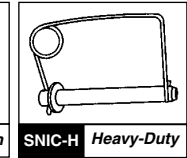
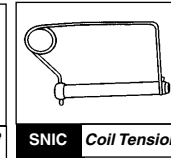
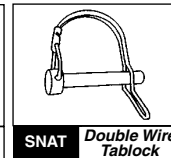
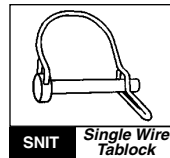
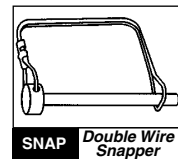
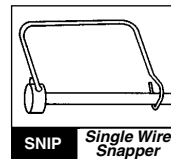

Self-Locking Pins

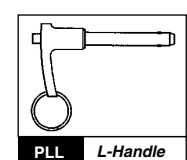
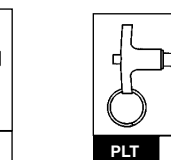
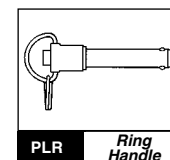
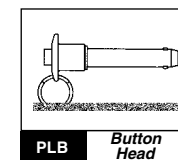
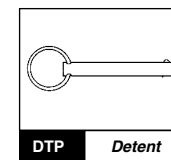

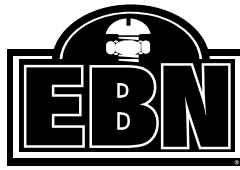

Cotter Pins

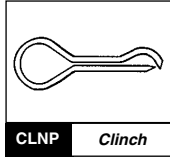
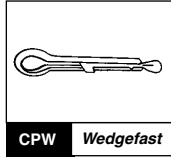
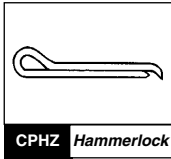
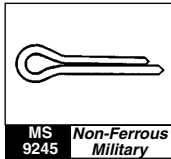
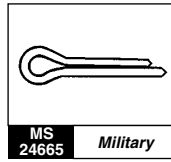
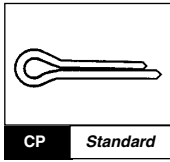

Hitch Pin Clips

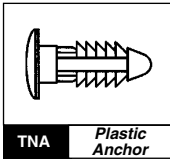
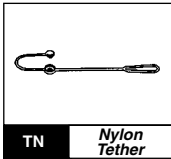
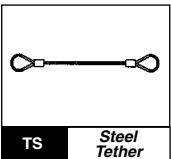
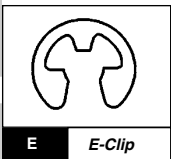
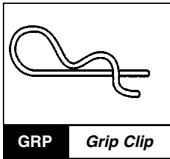
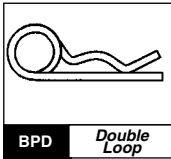
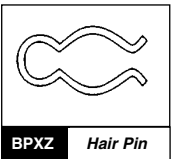
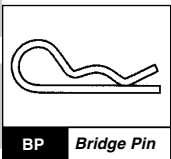

Wire Forms

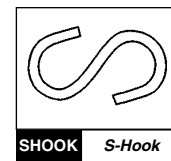
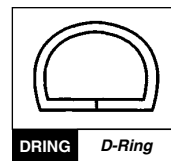
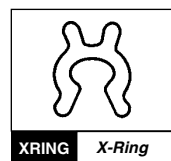
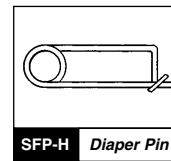
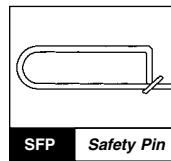
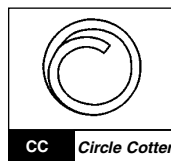
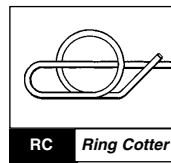
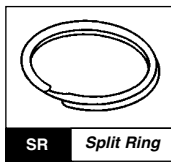
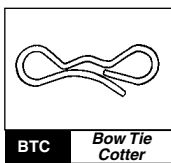

Rolled Pins

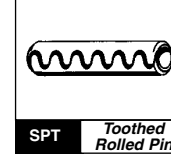
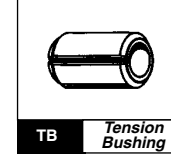
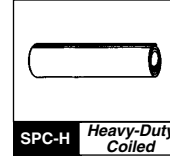
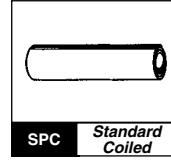
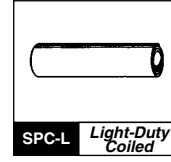
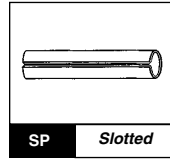

Grooved Pins

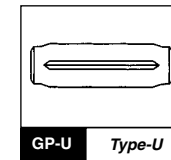
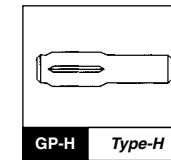
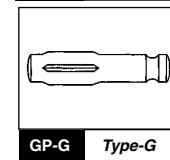
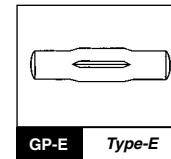
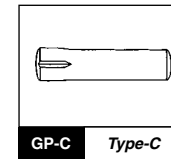
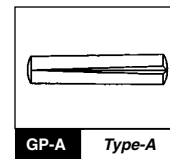

Tapered Pins

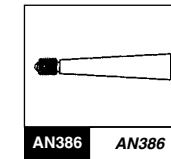
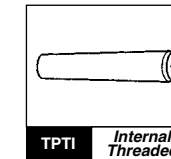
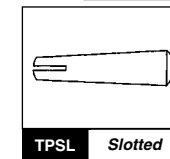
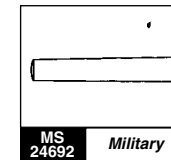
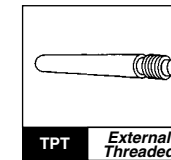
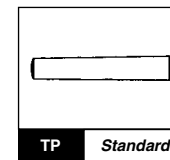

Dowel Pins

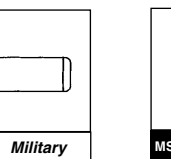
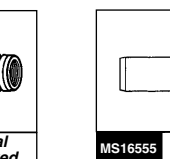
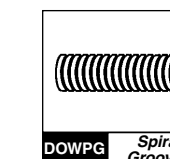
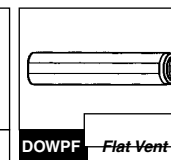
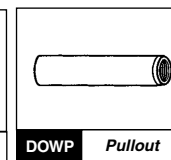
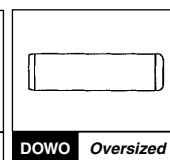
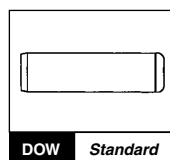

Evansville, IN 812-477-0077
 Jasper, IN 812-482-5105
 Vincennes, IN 812-882-4090



Henderson, KY 270-830-0077
 Owensboro, KY 270-684-0877
 Mt. Vernon, IL 618-244-7156

Crosby®

Wire Rope Clips

Crosby Clips

**GENUINE RED U-BOLT®
 G-450® Forged Steel Hot
 Dip Galvanized**



Size	Part No.	Size	Part No.
1/8	/7260005	1/2	/7260040
3/16	/7260007	9/16	/7260045
1/4	/7260010	5/8	/7260050
5/16	/7260020	3/4	/7260060
3/8	/7260030	7/8	/7260070
7/16	/7260035	1	/7260080

Chains

Spectrum 7 High Tensile Transport Chain

- High tensile carbon steel - heat treated
- Standard container - fibre drum
- Minimum ultimate load 4 times load limit.
- Finish - shot blasted
- Proof tested
- Proof load 2 times working load limit



Trade Size (in.)	Working Load Limit (lbs.)	Feet Per Drum	Weight Per 100 Feet (lbs.)	Part No.
1/4	3150	800	81	/7370090
5/16	4700	550	98	/7370100
3/8	6600	400	141	/7370110
7/16	8750	300	216	/7370115
1/2	11300	200	246	/7370120

Spectrum 7 Chain is not recommended for overhead lifting. Crosby Alloy Chain, Spectrum 3, should be used for these applications.

Spectrum® 8 Alloy Chain Spectrum® 10 Alloy Chain Available

- Alloy Steel - Heat Treated
- Finish - Bright
- Proof tested
- Proof load in excess of 2 times working



Trade Size (in.)	4 to 1 Design Factor - Working Load Limit* (lbs.)	Feet Per Drum	Weight Per 100 Feet (lbs.)	Drum Part No.
9/32 (1/4)	3,500	500	72	/7370130
5/16	4,500	500	114	/7370135
3/8	7,100	500	148	/7370140
1/2	12,000	300	243	/7370150
5/8	18,100	200	351	/7370160
3/4	28,300	100	584	/7370170
7/8	34,200	100	705	/7370180

The design factor of 4 to 1 for Spectrum Alloy Chain agrees with the design factor used by the International Standards Organization (ISO) and is the preferred set of working load limit values to be used. *Minimum ultimate load is 4.0 times the working load limit.

Only Alloy Chain, Spectrum 8, should be used in overhead lifting applications.

Lok-A-Loy® 8 Alloy Connecting Link



Grade 8 Chain Size (in.)	Part No.
9/32 (1/4)	/1014720
5/16	/1014584
3/8	/1014721
1/2	/1014722
5/8	/1014723
3/4	/1014724
7/8	/1014725
1	/1014727
1-1/4	/1014728

Product test certification included with products.

Hooks

Clevis Grab Hook A-338



Chain Size	Part No.
9/32 (1/4)	/1027659
3/8	/1027677
1/2	/1027686
5/8	/1027695
3/4	/1027702
7/8	/1027711

Proof test certification included with product.

Eye Sling Hook A-327



Chain Size	Part No.
9/32 (1/4)	/1003764
3/8	/1003773
1/2	/1003782
5/8	/1003791
3/4	/1003808
7/8	/1003817

Proof test certification included with product.

LEBUS®

Load Binders L-150 With Standard Hooks



Size No.	MIN-MAX Chain Size (in.)	Part No.
7-1	5/16-3/8	/1048128
A-1	3/8-1/2	/1048146
C-1	1/2-5/8	/1048164

L-140 Ratchet Type



Size No.	MIN-MAX Chain Size (in.)	Part No.
R-7	5/16-3/8	/1048404
R-A	3/8-1/2	/1048422

“Children seldom misquote you. In fact, they usually repeat word for word what you shouldn’t have said.”

—Unknown